

RIDING LAWNMOWER
80XC - S/N 14064330 and after
80XE, 80XM - all
GRASS BAGGER
M91, B95
M92 THATCHER
Parts Catalog No. 8-2971

NOTE: This catalog replaces
catalog 8-2970

11-87-RP-500-296

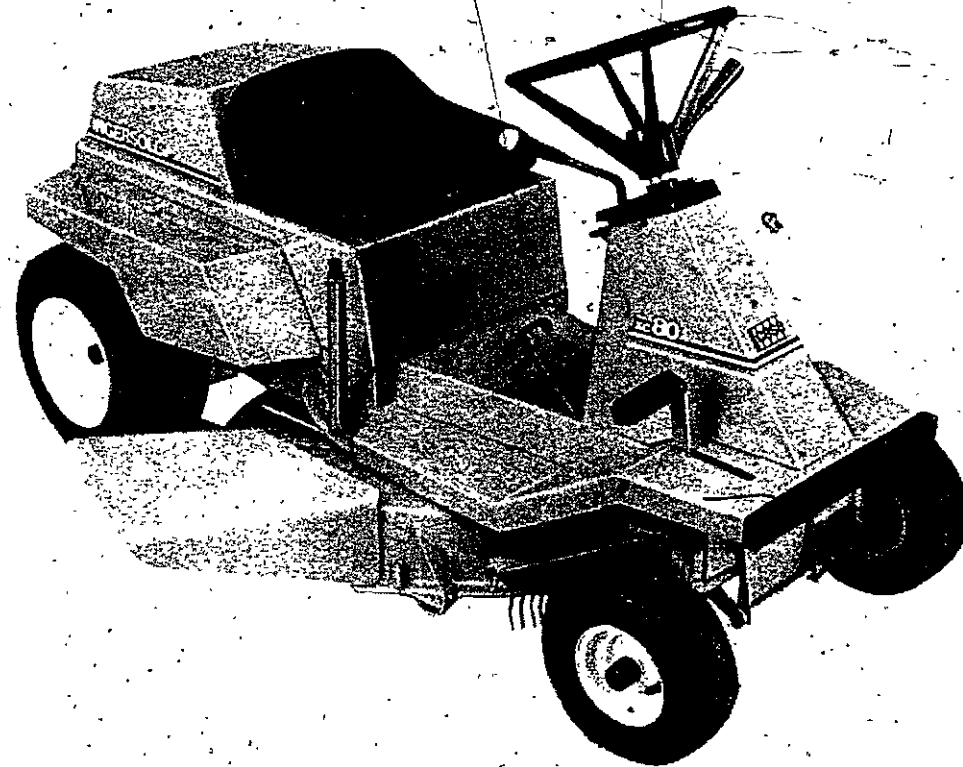

MODEL 80XC

ALPHABETICAL INDEX
ENGINE AND ATTACHING PARTS

	PAGE	GRID
Air Cleaner	13	A14
Air Ducts	17	B4
Carburetor	15	B2
Control, Choke and Throttle	13	A14
Engine Block	5-7	A6-A8
Exhaust	15	B2
Flywheel and Stator	9	A10
Fuel System	13	A14
Governor	11	A12
Ignition and Charging	9	A10
Magneto	11	A12
Mounts, Engine	17	B4
Oil Drain and Fill	9	A10
Starter Motor	19	B6

BASIC RIDING LAWNMOWER

Axle, Front	37	C10
Axle, Rear	45	D4
Belt, Mower Drive	53	D12
Belt, Traction Drive	41	C14
Chain, Drive	45	D4
Clutch and Brake Assembly	47	D6
Control Tower	31-33	C4-C6
Decals	27-29	B14-C2
Drive Shaft Assembly	43	D2
Electrical System	19-25	B6-B12
Electrical System Hardware	21	B8
Enclosure Engine	35	C8
Frame	31-33	C4-C6
Jackshaft Assembly	43	D2
Mower Deck	51	D10
Mower Drive Assembly	53	D12
Mower Drive Control	49	D8
Mower Height and Lift Control	49	D8
Neutral Start Switch Assembly	21	B8
Seat	35	C8
Steering Assembly	37	C10
Transmission Drive Pivot	41	C14
Travel Control	39	C12
Wheels, Front and Rear	35	C8

MODEL B95 BAGGER ATTACHMENT

Entire Parts List	55	D14
-------------------------	----	-----

MODEL M92 THATCHER ATTACHMENT

Entire Parts List	57	E2
-------------------------	----	----

MODEL B93 REAR STAND KIT

Entire Parts List	55	D14
-------------------------	----	-----

GENERAL INFORMATION

INDEX

There is an index at the front and rear of this catalog.

The front index is an alphabetical index of the major groups or assemblies.

The rear index is a numerical index of the part numbers and pages on which these numbers are shown.

ILLUSTRATION

Each illustration in this catalog shows a group of parts or components. These parts and components are aligned approximately as the parts and components on your machine. Each part and component in an illustration has a reference number. These reference numbers are in a list on the page opposite of the illustration. Next to the reference number is the part number, description and required quantity of the part shown in the illustration.

ABBREVIATIONS

UAR - "Use as required" indicates that the part quantity is variable.

NSS - "Not sold separately" indicates that the part is only available as a component of an assembly or the part must be purchased locally. If the part is an assembly component, the description will be indented under the assembly description in the parts list.

INDENTED DESCRIPTIONS

An assembly can have many components. The components of an assembly are indicated by an indented description. The quantity for an indented part is the total needed for that complete assembly. See the example.

REF.	PART NO	DESCRIPTION	REQ'D
	C 55159	CYLINDER ASSY - rear steering	1
28	C 56208	SOCKET ASSY - rear cylinder	1
29	C 55956	PLUG - adjusting, socket assy	1
30	C 55957	SEAT - socket ball	2
31	C 56210	SPRING - socket	1
32	C 56209	SEAT - socket spring	1
33	C 45175	CLAMP ASSY - socket assy	1
	16- 836	BOLT - 1/2" x 2-1/4" N.F. hex	1
34	132- 104	PIN - cotter, 3/16" x 3"	1
35	C 55889	STUD - ball, socket & cylinder	2
36	13- 410	BOLT - 1/4" x 5/8" N.C., hex	4
37	92- 4	LOCKWASHER - 1/4" SAE	4

PARTS ORDERS

All orders must include the following information:

1. Correct part number.
2. Complete description of part or component.
3. Total quantity of each part or component.
4. Product model number.
5. All necessary product identification numbers.
6. Method for sending the parts.
7. Complete and correct address.

CATALOG REVISIONS

As the product changes, we will send you new pages for your catalog.

IMPORTANT: Put all revisions into the catalog as soon as possible.

RIGHT HAND AND LEFT HAND IDENTIFICATION

The words right hand (RH) and left hand (LH) as used in this catalog indicate the direction while you are in the operator's seat in the normal operating position.

PRODUCT IDENTIFICATION NUMBERS

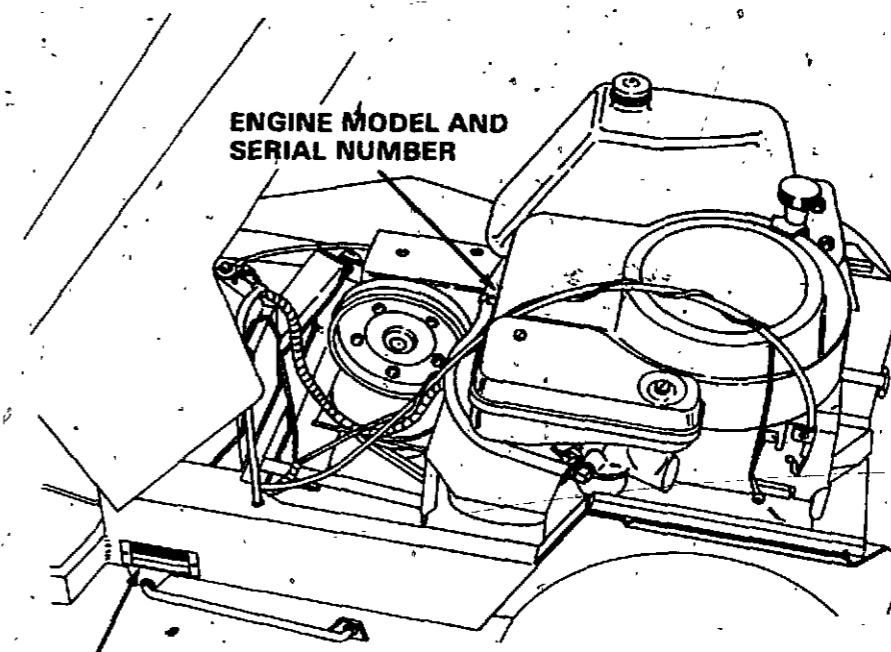

LAWNMOWER MODEL AND PRODUCT IDENTIFICATION NUMBER (P.I.N.)

LAWNMOWER MODEL NUMBER	ENGINE MODEL NUMBER
80XE 80XC Before S/N 14081384	BRIGGS AND STRATTON 190707 ENGINE NUMBER C27159
80XM	BRIGGS AND STRATTON 190702 ENGINE NUMBER C29095
80XC S/N 14081384 and after	BRIGGS AND STRATTON - 192707 ENGINE NUMBER C30148

NOTE: This catalog contains references to serial numbers. Use these serial numbers as a guide to order the correct part.

ENGINE BLOCK ASSEMBLY

(For Complete Engine See Page 1)

80XE, 80XM

80XC - before S/N 14081384

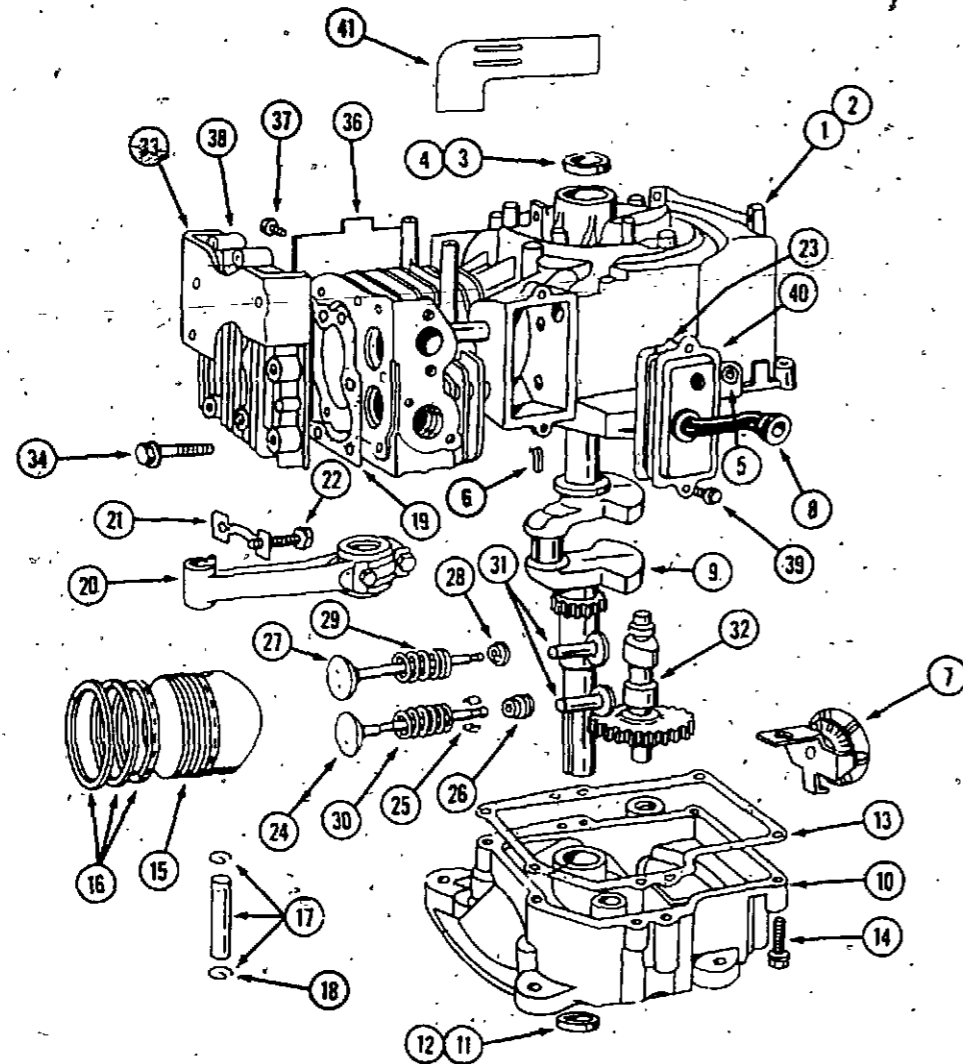

REF.	PART NO.	DESCRIPTION	REQ'D
1	C 29924	BLOCK ASSEMBLY - short	1
2	NSS	BLOCK - cylinder, stripped	1
3	BR 295962	BUSHING - cylinder	1
4	BR 294606	SEAL - oil	1
5	BR 231055	BUSHING - governor shaft	1
6	C 27236	KEY - flywheel	1
7	BR 392718	BRACKET ASSEMBLY - governor gear & oil slinger	1
8	BR 280005	TUBE - breather	1
9	BR 261038	CRANKSHAFT - (80XC, 80XE)	1
9	C 29775	CRANKSHAFT - (80XM)	1
10	BR 392548	OIL PAN ASSEMBLY	1
11	BR 295963	BUSHING - oil pan	1
12	C 25709	SEAL - oil	1
13	BR 27750	GASKET - oil pan 1/64" (0.40 mm)	1
13	BR 27876	GASKET - oil pan .005" (0.13 mm)	1
13	BR 27877	GASKET - oil pan .009" (0.23 mm)	1
14	NSS	SCREW - oil pan mtg. (use 113-120 and 192-20)	4
15	BR 391673	PISTON ASSEMBLY - standard	1
15	BR 391674	PISTON ASSEMBLY - .010" (0.25 mm) oversize (includes rings)	1
15	BR 391675	PISTON ASSEMBLY - .020" (0.51 mm) oversize (includes rings)	1
15	BR 391676	PISTON ASSEMBLY - .030" (0.76 mm) oversize (includes rings)	1
16	C 29776	RING SET - standard	1
16	BR 391670	RING SET - .010" (0.25 mm) oversize	1
16	BR 391671	RING SET - .020" (0.51 mm) oversize	1
16	BR 391672	RING SET - .030" (0.76 mm) oversize	1
17	BR 295840	PIN ASSEMBLY - piston standard (includes locks)	1
17	BR 295841	PIN ASSEMBLY - piston, .005" (0.13 mm) oversize (includes locks)	1
18	BR 68546	LOCK - piston pin	1
19	BR 270430	GASKET - cylinder head	1
20	BR 390402	CONNECTING ROD ASSEMBLY	1
21	BR 222114	LOCK - connecting rod bolt	1
22	BR 92659	BOLT - connecting rod	2
23	C 27350	GASKET - valve cover	1
24	BR 390419	VALVE - exhaust	1
25	BR 93630	LOCK - exhaust valve	2
26	BR 292260	ROTATOR - exhaust valve	1
27	BR 261055	VALVE - intake	1
28	BR 221596	KEEPER - intake valve	1
29	BR 65906	SPRING - intake valve	1
30	BR 26828	SPRING - exhaust valve	1
31	BR 260933	TAPPET - valve	2
32	BR 211689	CAMSHAFT	1
33	BR 222636	BAFFLE - cylinder head	1
34	BR 93723	BOLT - cylinder head, 3"	UAR
34	BR 93211	BOLT - cylinder head, 2-21/32"	UAR
36	BR 222830	BAFFLE - cylinder	1
37	NSS	SCREW - baffle mtg. (use 163-18 and 192-18)	1
38	BR 212286	HEAD - cylinder	1
39	BR 187-1508	SCREW - sems	2
40	BR 391406	BREATHING - crankcase	1
41	BR 221760	GUIDE - air	1
	BR 299577	GASKET SET - includes items 13, 19, 23 and carburetor mounting gasket	1

ENGINE BLOCK ASSEMBLY
(For Complete Engine See Page 1)
Use on 80XC - S/N 14081384 and after

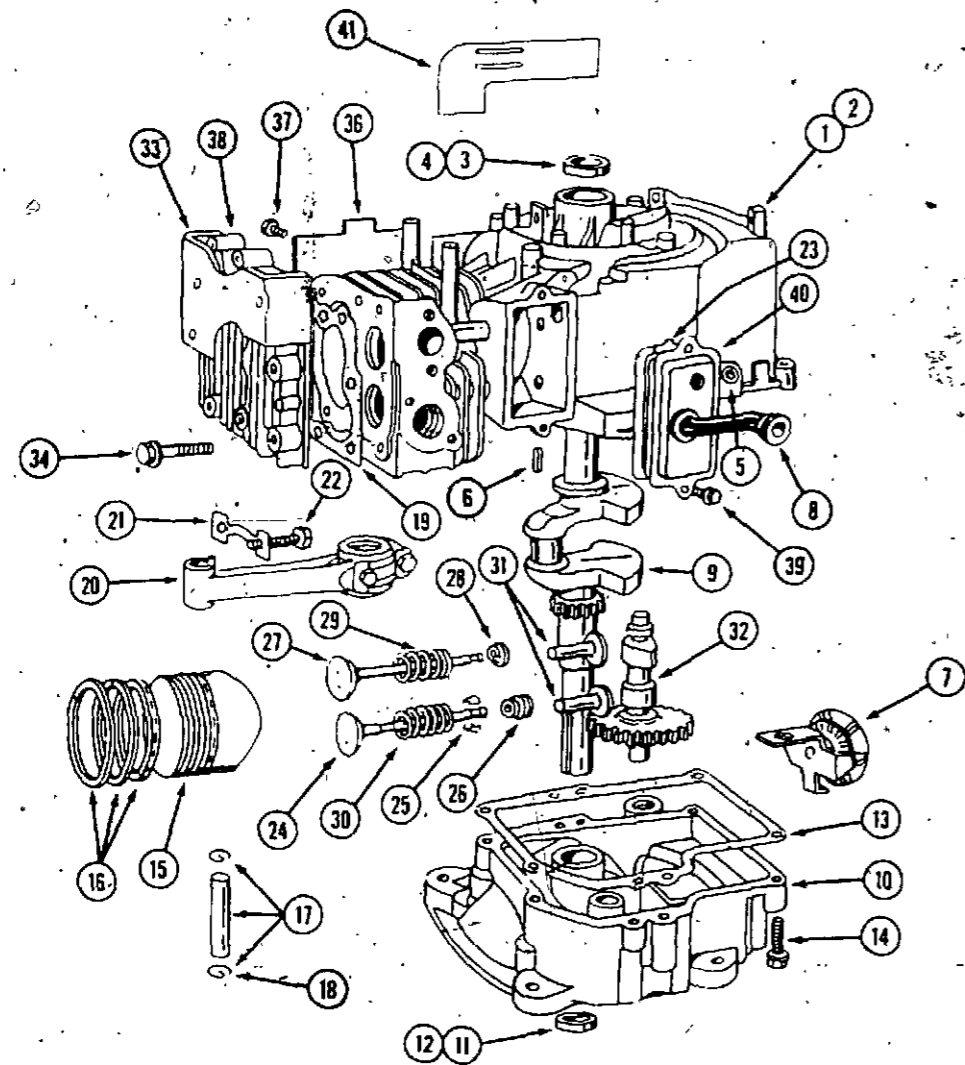

REF.	PART NO.	DESCRIPTION	REQ'D
1	C 29924	BLOCK ASSEMBLY - short	1
2	NSS	BLOCK - cylinder, stripped	1
3	C 30396	BUSHING - cylinder	1
4	BR 294606	SEAL - oil	1
5	BR 231055	BUSHING - governor shaft	1
6	C 27236	KEY - flywheel	1
7	BR 392718	BRACKET ASSEMBLY - governor gear & oil slinger	1
8	BR 280005	TUBE - breather	1
9	C 29775	CRANKSHAFT	1
10	BR 392548	OIL PAN ASSEMBLY	1
11	BR 295963	BUSHING - oil pan	1
12	C 25709	SEAL - oil	1
13	BR 27750	GASKET - oil pan 1/64" (0.40 mm)	1
13	BR 27876	GASKET - oil pan .005" (0.13 mm)	1
13	BR 27877	GASKET - oil pan .009" (0.23 mm)	1
14	NSS	SCREW - oil pan mtg. (use 113-120 and 192-20)	4
15	C 30397	PISTON ASSEMBLY - standard	1
15	C 30398	PISTON ASSEMBLY - .010" (0.25 mm) oversize (includes rings)	1
15	C 30399	PISTON ASSEMBLY - .020" (0.51 mm) oversize (includes rings)	1
15	C 30400	PISTON ASSEMBLY - .030" (0.76 mm) oversize (includes rings)	1
16	C 29776	RING SET - standard	1
16	C 30401	RING SET - .010" (0.25 mm) oversize	1
16	C 30402	RING SET - .020" (0.51 mm) oversize	1
16	C 30403	RING SET - .030" (0.76 mm) oversize	1
17	BR 295840	PIN ASSEMBLY - piston standard (includes locks)	1
17	BR 295841	PIN ASSEMBLY - piston, .005" (0.13 mm) oversize (includes locks)	1
18	BR 68546	LOCK - piston pin	1
19	BR 270430	GASKET - cylinder head	1
20	BR 390402	CONNECTING ROD ASSEMBLY	1
21	BR 222114	LOCK - connecting rod bolt	1
22	BR 92659	BOLT - connecting rod	2
23	C 27350	GASKET - valve cover	1
24	C 30404	VALVE - exhaust	1
25	BR 93630	LOCK - exhaust valve	2
26	BR 292260	ROTATOR - exhaust valve	1
27	BR 261055	VALVE - intake	1
28	BR 221596	KEEPER - intake valve	1
29	BR 65906	SPRING - intake valve	1
30	BR 26828	SPRING - exhaust valve	1
31	BR 260933	TAPPET - valve	2
32	BR 211689	CAMSHAFT	1
33	BR 222636	BAFFLE - cylinder head	1
34	BR 93723	BOLT - cylinder head, 3"	1
34	BR 93211	BOLT - cylinder head, 2-21/32"	1
36	BR 222830	BAFFLE - cylinder	1
37	NSS	SCREW - baffle mtg. (use 163-18 and 192-18)	1
38	BR 212286	HEAD - cylinder	1
39	187- 1508	SCREW - sems	2
40	BR 391406	BREATHER - crankcase	1
41	BR 221760	GUIDE - air	1
	BR 299577	GASKET SET - includes items 13, 19, 23 and carburetor mounting gasket	1

UAR
UAR

80XC, 80XE

80XM

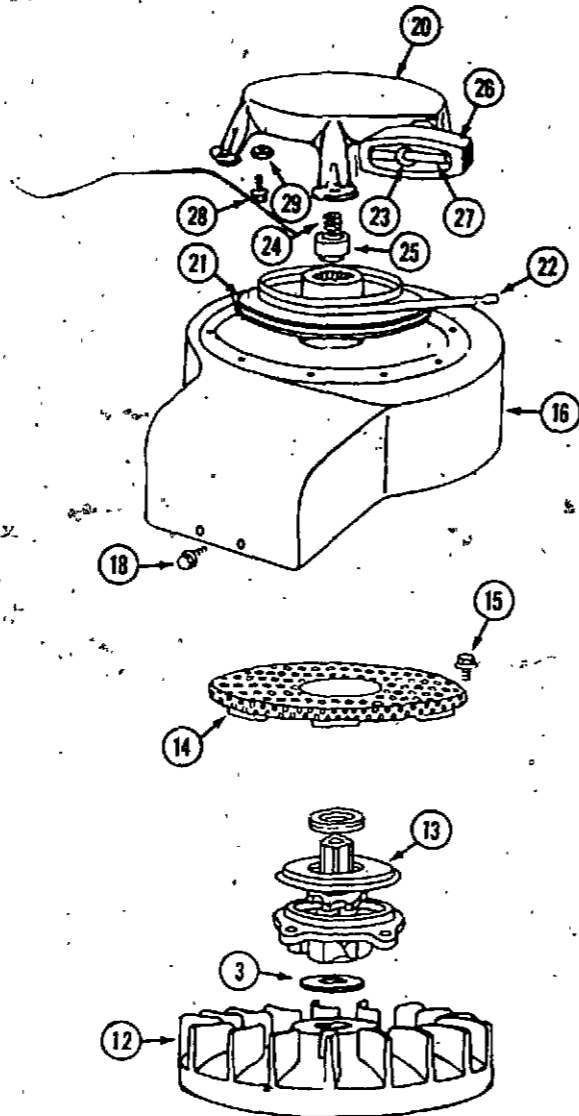
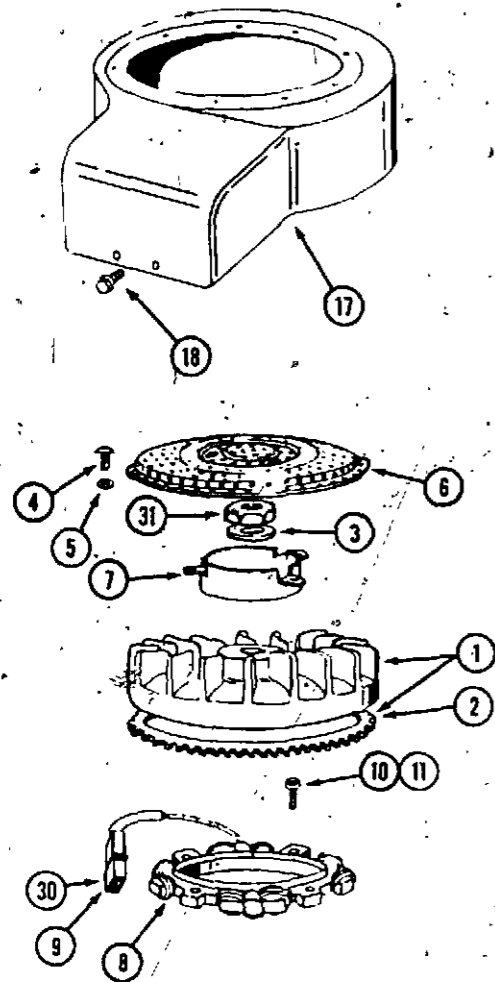

MODEL 80XC, 80XE AND 80XM RIDING LAWNMOWER

FLYWHEEL AND STATOR

REF.	PART NO.	DESCRIPTION	REQ'D
1	BR 391983	FLYWHEEL ASSEMBLY - (80XC, 80XE)	1
2	BR 392133	RING GEAR - (80XC, 80XE)	1
3	BR 220865	WASHER - spring	1
4	182- 84	SCREW - No. 8-32 x 3/8"	3
5	193- 25	LOCK WASHER - No. 8	3
6	BR 222562	SCREEN - flywheel (80XC, 80XE)	1
7	BR 222561	CUP - screen mounting (80XC, 80XE)	1
8	C 29867	STATOR - alternator (80XC, 80XE)	1
9	C 29865	DIODE AND CONNECTOR ASSEMBLY - (80XC, 80XE)	1
10	182- 90	SCREW - No. 8 - 32 x 1"	4
11	195- 10	WASHER - No. 8	4
12	C 29783	FLYWHEEL - (80XM)	1
13	C 29792	CLUTCH ASSEMBLY - rewind (80XM)	1
14	C 29793	SCREEN - flywheel (80XM)	1
15	N S S	SCREW - retaining (use 163-7 and 193-25) 80XM	3
16	C 29784	HOUSING - blower (80XM)	1
17	BR 391379	HOUSING - blower (80XC, 80XE)	1
18	NSS	BOLT - retaining (use 22-48 and 92-4)	4
	C 29926	HOUSING ASSEMBLY - rewind (80XM)	1
20	NSS	HOUSING - rewind (80XM)	1
21	C 29787	PULLEY - rewind (80XM)	1
22	C 29788	SPRING - rewind (80XM)	1
23	C 29789	ROPE - pull - start (80XM)	1
24	C 29790	SPRING - tension (80XM)	1
25	C 29791	ADAPTER - pulley (80XM)	1
26	C 29925	GRIP - pull - start (80XM)	1
27	NSS	PIN - retaining (80XM)	1
30	C 29866	CONNECTOR - harness	1
31	BR 92284	NUT - flywheel (80XC, 80XE)	1

OIL DRAIN AND FILL

1	187- 1037	SCREW - clamp mounting	1
2	BR 222502	CLAMP - oil filler tube	1
3	BR 391840	DIPSTICK - oil	1
4	BR 68838	SEAL - filler tube	1
5	BR 280133	TUBE - oil filler	1
6	BR 270920	SEAL - filler cap	1
7	217- 1027	ELBOW - 90° street	1
8	C 18814	NIPPLE - pipe	1
9	C 14906	GASKET - plug, oil drain	1
10	C 14399	PLUG - oil drain	1

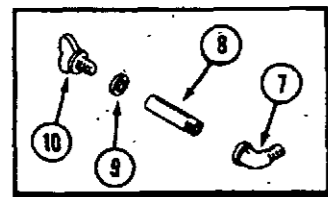

OIL DRAIN

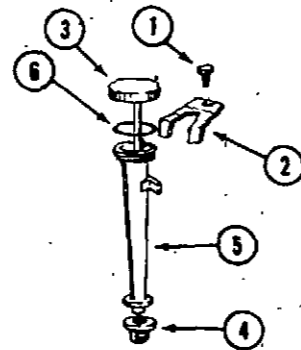

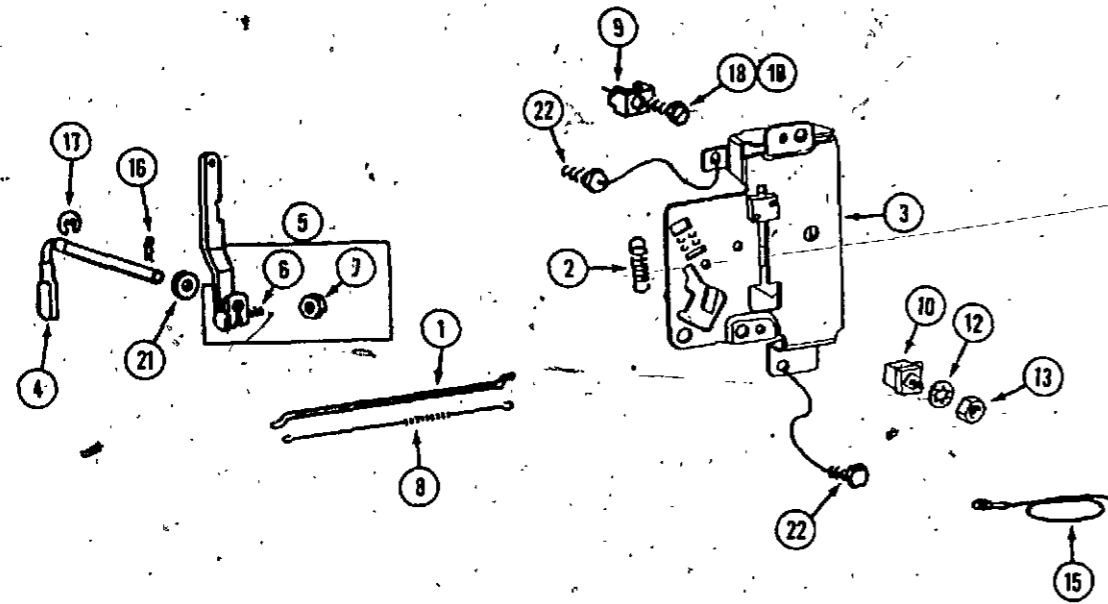

GOVERNOR

REF.	PART NO.	DESCRIPTION	REQ'D
1	C 27242	LINK - governor	1
2	BR 261306	SPRING - governor	1
3	C 27257	BRACKET - governor (80XC, 80XE)	1
3	C 29795	BRACKET - governor (80XM)	1
4	BR 231058	CRANK - governor	1
5	BR 391733	LEVER ASSEMBLY	1
6	11- 312	BOLT - lever	1
7	129- 7	NUT - No. 10-24	1
8	C 27241	SPRING - governor link	1
9	BR 221535	CLAMP - casing	1
10	C 29794	INSULATOR ASSEMBLY	1
12	193- 25	LOCKWASHER	2
13	129- 6	NUT - No. 8-32	2
15	C 29796	WIRE - ground	1
16	136- 103	PIN - cotter hair pin	1
17	C 28643	RETAINER - "E" ring	1
18	163- 4	SCREW	1
19	92- 3	WASHER	1
21	BR 222450	WASHER - governor crank	1
22	187- 1510	SCREW - mounting	1

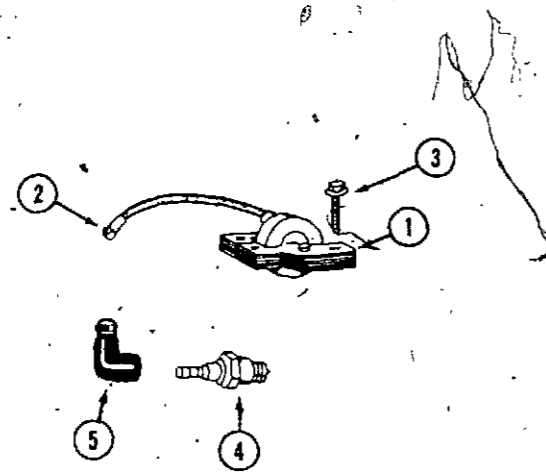

MAGNETO ARMATURE

1	C 29785	ARMATURE - magneto	1
2	BR 221798	TERMINAL - ignition cable	1
3	N S S	SCREW mounting (use 182-549 and 195-10)	2
4	C 24329	SPARK PLUG - resistor	1
5	BR 66538	BOOT - spark plug	1

FUEL SYSTEM

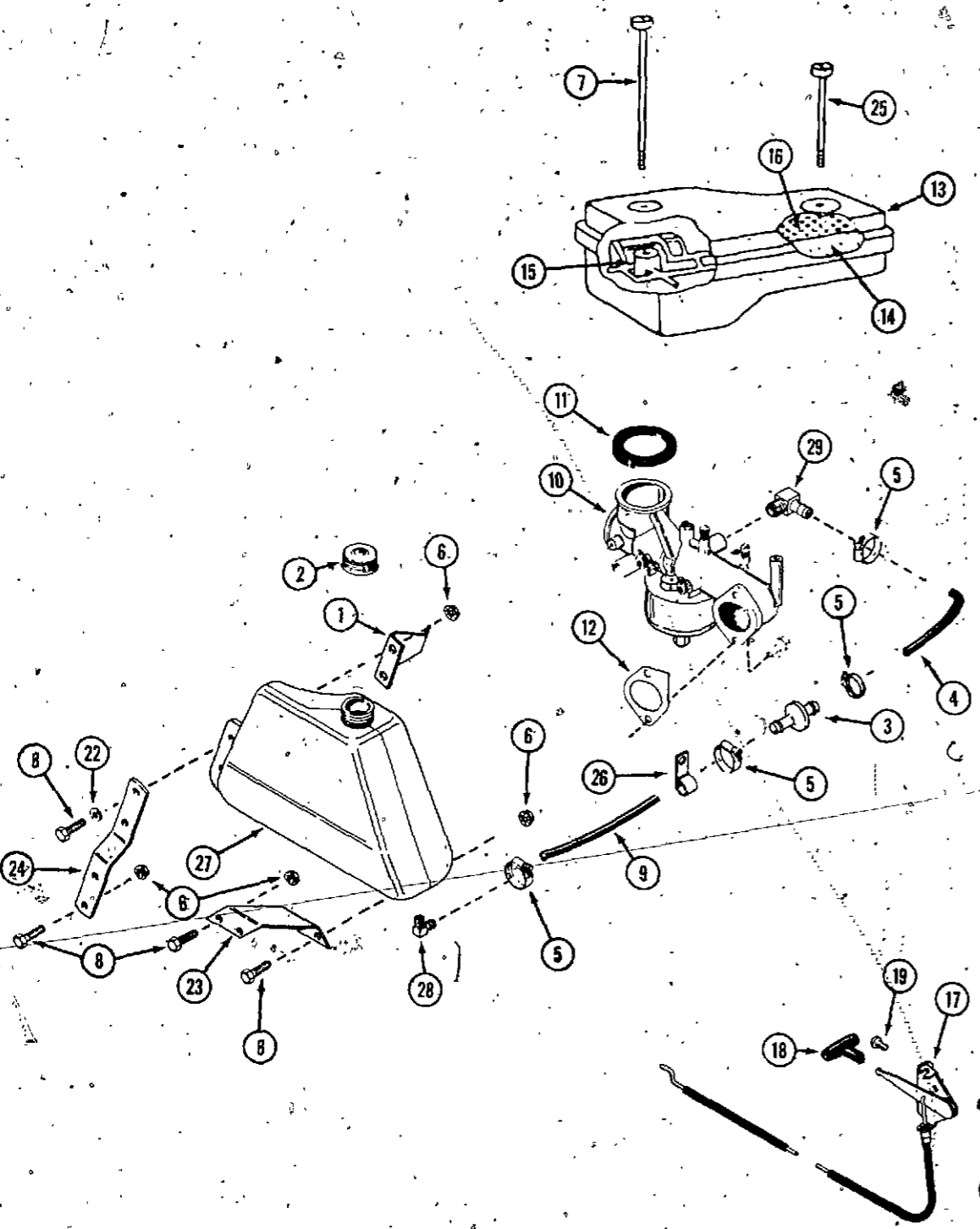

REF.	PART NO.	DESCRIPTION	REQ'D
1	NSS	STABILIZER - fuel tank (use C30121)	1
2	C 11529	CAP - fuel tank (includes insert)	1
3	C 28935	FILTER - fuel	1
4	C 28937	HOSE - fuel (cut to length)	1
5	214- 251	CLAMP - hose	4
6	131- 911	NUT - 5/16" - 18 flange lock	UAR
7	BR 93323	SCREW - air cleaner	1
8	113- 102	BOLT - 5/16" - 18 x 3/4"	8
9	C 28937	HOSE - fuel (cut to length)	1
10	BR 390811	CARBURETOR - (repairs page 15)	1
11	BR 270539	GASKET - air cleaner	1
12	BR 270824	GASKET - carburetor mounting	1
13	BR 391399	CLEANER ASSEMBLY - air	1
14	BR 270528	ELEMENT - air cleaner	1
15	BR 280111	SUPPORT - element	1
	C 26358	CUP - air cleaner	1
16	C 29782	SCREEN - air cleaner	1
	C 29781	SPACER - air cleaner	1
17	C 29113	CONTROL - choke and throttle (80XE, 80XM)	1
17	C 23641	CONTROL - choke and throttle (80XC)	1
18	C 15540	HANDLE - control	1
19	182- 559	SCREW - #10 - 24 x 3/4" pan hd. Phillips	2
20	192- 18	LOCKWASHER #10 - 24 hex	2
21	129- 17	NUT - #10 - 24 hex	2
22	195- 521	WASHER - 5/16"	2
23	C 25145	BRACKET - tank mount, front (80XC)	1
24	NSS	BRACKET - tank mount, rear (use C30121)	1
25	BR 93622	SCREW - air cleaner	1
26	C 24689	CLIP - fuel line	1
27	C 25125	TANK - fuel	1
28	C 10657	ELBOW ASSEMBLY - tank	1
29	C 10678	CONNECTOR - fuel line	1

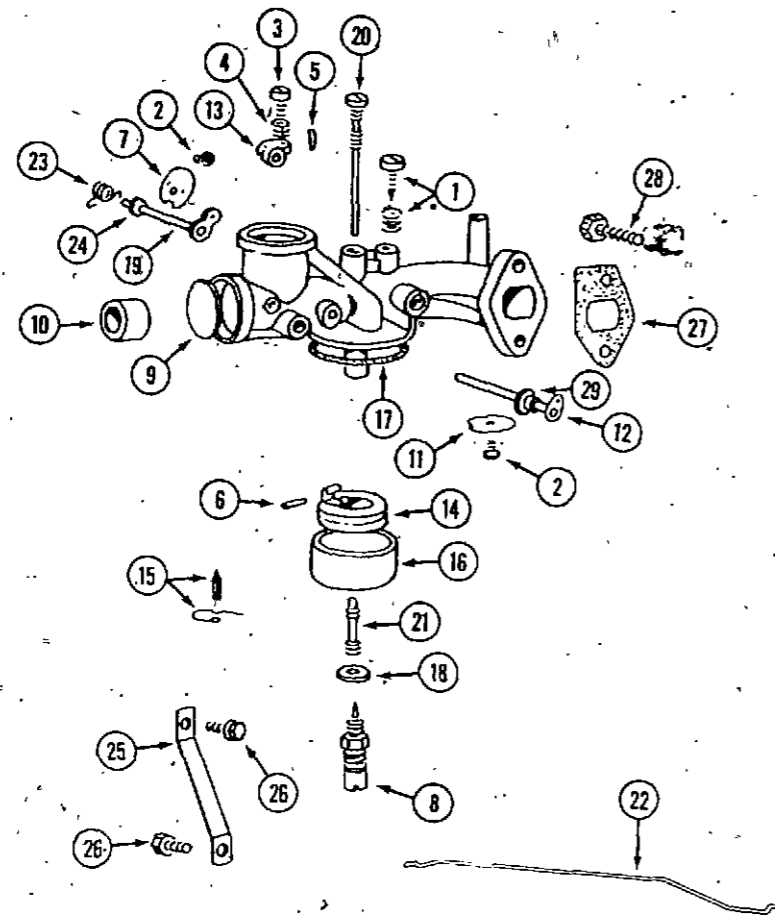

80XC - before S/N 14081384
80XE, 80XM - all

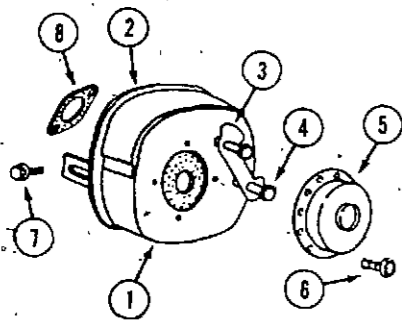

80XC - S/N 14081384 and after

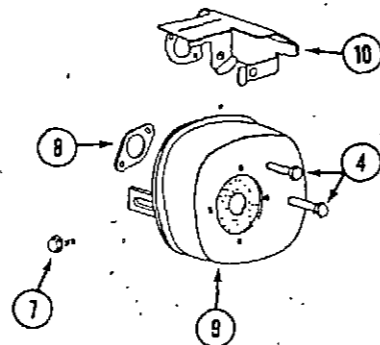

CARBURETOR

REF.	PART NO.	DESCRIPTION	REQ'D
	BR 390811	CARBURETOR	1
1	BR 292681	VALVE - idle (includes spring)	1
2	BR 93499	SCREW - throttle and choke valve mounting	3
3	182- 87	SCREW - No. 8-32 x 5/8"	1
4	BR 26157	SPRING -throttle adjustment	1
5	138- 251	PIN - throttle stop	1
6	BR 230896	PIN - float hinge	1
7	BR 222010	VALVE - choke	1
8	C 29779	VALVE - needle	1
9	41- 24	PLUG - welch	1
10	BR 211682	VENTURI	1
11	BR 221986	VALVE - throttle	1
12	BR 391512	SHAFT AND LEVER - throttle	1
13	BR 211712	STOP - throttle	1
14	BR 299707	FLOAT - fuel	1
15	C 27254	VALVE - fuel inlet	1
16	BR 221995	BOWL - float	1
17	BR 270511	GASKET - float bowl	1
18	BR 222014	WASHER - float bowl	1
19	BR 390684	SHAFT AND LEVER - choke	1
20	BR 299740	NOZZLE - fuel	1
21	C 29780	SCREW - nozzle	1
22	C 27243	LINK - choke	1
23	BR 261116	SPRING - choke return	1
24	BR 270382	WASHER - choke shaft	1
25	BR 222027	BRACKET - mounting	1
26	187- 1510	SCREW - mounting	2
27	BR 270824	GASKET - carburetor mounting	1
28	BR 93357	SCREW - mounting	2
29	C 30405	SEAL - throttle shaft	1
	C 27255	KIT - carburetor overhaul (includes 1, 6, 8, 9, 15, 17, 18, 20, and 21)	1

EXHAUST SYSTEM

1	BR 391313	MUFFLER - exhaust	1
2	BR 221885	SHIELD - heat	1
3	BR 222263	LOCK - bolt	1
4	C 27237	BOLT - muffler	2
5	C 29258	DEFLECTOR - exhaust (80XE, 80XM)	1
6	187- 1041	SCREW -special	4
7	NSS	SCREW - (use 22-412 and 195-18)	1
8	C 24340	GASKET - exhaust	1
9	C 30407	MUFFLER - exhaust	1
10	C 30408	SHIELD - heat, muffler	1

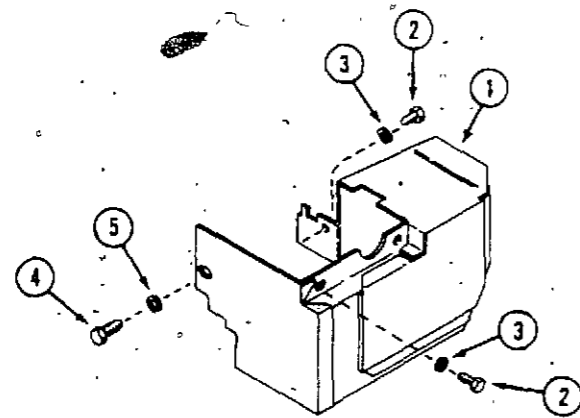
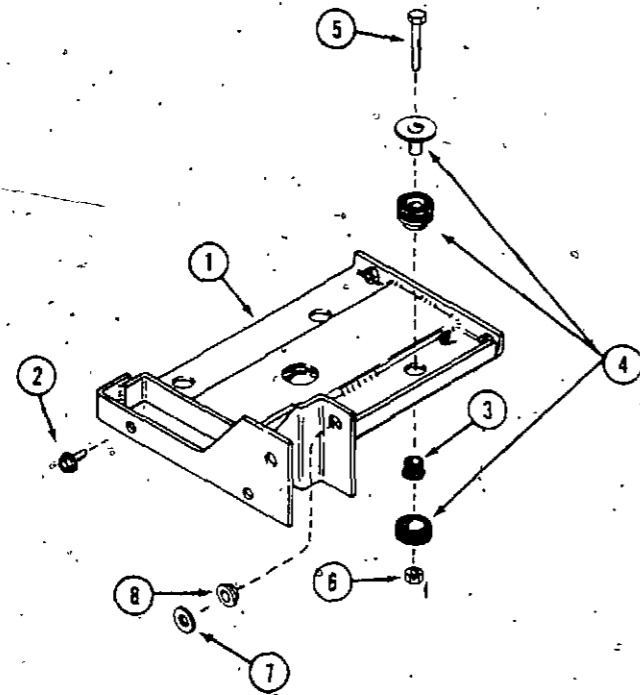

ENGINE MOUNTS

REF.	PART NO.	DESCRIPTION	REQ'D
1	C 25030	PLATE - engine mounting (80XC)	1
2	121- 106	BOLT - 5/16" - 18x 1/2" flange hd.	4
3	C 24506	BUSHING - rubber	4
4	C 25468	MOUNT ASSEMBLY - engine	4
5	113- 111	BOLT - 5/16" - 18 x 2-1/2" hex	4
6	131- 69	NUT - lock 5/16" - 18 hex	4
7	C 28806	SHIM - washer	UAR
8	C 24182	BUSHING - flange	2

ENGINE AIR DUCT

1	C 25859	DUCT - air exhaust	1
2	113- 1	BOLT - 1/4" - 20 X 1/2" hex	2
3	192- 19	LOCK WASHER - 1/4"	2
4	113- 101	BOLT - 5/16" - 18 x 1/2" hex	1
5	192- 20	LOCK WASHER - 5/16"	1
	C 26640	PLUG - button	1

STARTER MOTOR — BRIGGS

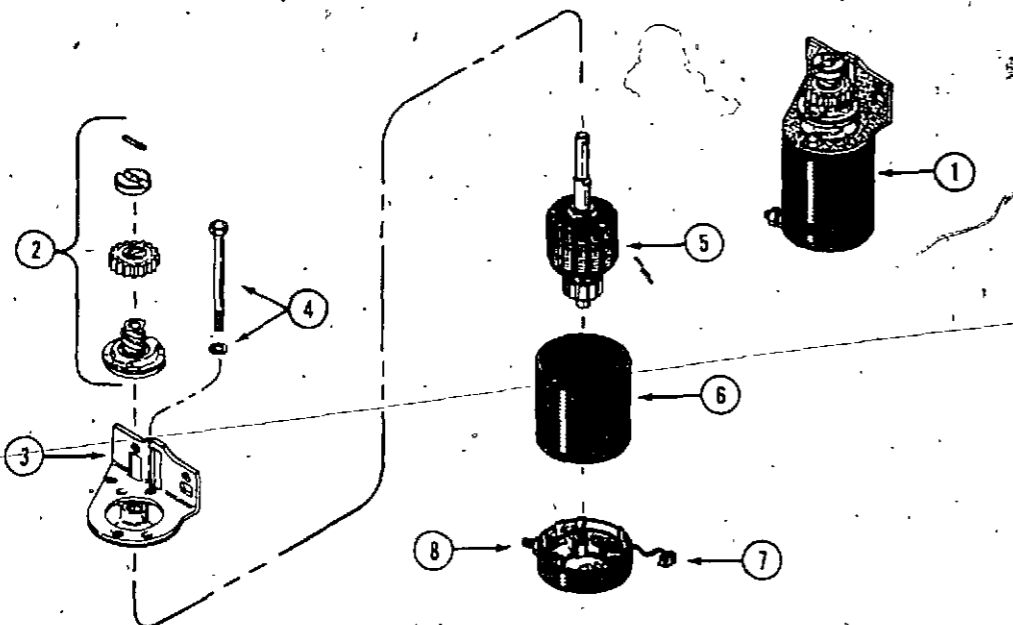

REF.	PART NO.	DESCRIPTION	REQ'D
1	C 27264	MOTOR - starting 12V, Briggs	1
2	BR 391461	DRIVE ASSEMBLY - starter	1
3	C 27262	END CAP - starter	1
4	C 27260	BOLT ASSEMBLY - thru (includes washer)	1
5	C 26359	ARMATURE - starter	1
6	C 27263	HOUSING - starter	1
7	C 27259	BRUSH ASSEMBLY - starter	1
8	C 27258	END CAP - com. end (includes brushes)	1

NEUTRAL START SWITCH ACTUATOR

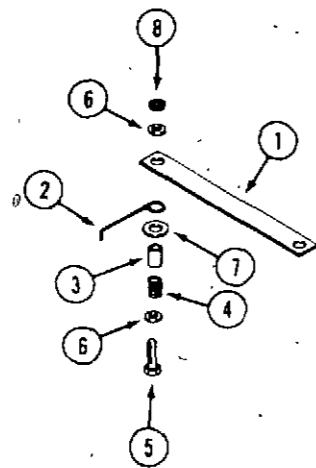

REF.	PART NO.	DESCRIPTION	REQ'D
1	C 25536	STRAP - actuator	1
2	C 25537	WIRE - actuator	1
3	C 25538	SPACER	1
4	C 19867	SPRING - compression	1
5	113- 17	BOLT - 1/4" - 20 x 1-1/4" hex	1
6	195- 518	WASHER - 1/4"	2
7	195- 525	WASHER - 3/8"	1
8	131- 1180	NUT - lock 1/4" - 20 hex	1

ELECTRICAL SYSTEM HARDWARE

1	C 24263	STRAP - battery hold down	1
2	C 28644	HOSE - vent	1
3	C 24428	CUSHION - battery	1
4	195- 516	WASHER - 3/16"	2
5	192- 19	LOCKWASHER - 1/4"	4
6	129- 101	NUT - 1/4" - 20 hex	4
7	C 27751	KEY AND RING ASSEMBLY	1
8	C 23248	LOCKWASHER - 5/8" internal-tooth	1
9	C 24659	NUT - 5/8" - 32 knurled	1
10	C 22947	TIE - wire	UAR
11	169- 145	BOLT - 1/4" - 20 x 5/8"	2
12	182- 10	SCREW - No. 4 - 40 x 7/8" pan head	4
13	129- 13	NUT - No. 4 - 40 hex	4
14	192- 13	LOCKWASHER - No. 4	4
15	129- 37	NUT - No. 10 - 32	5
16	192- 18	LOCKWASHER - 3/16"	5
17	182- 147	SCREW - No. 10 x 3/4"	3
18	182- 547	SCREW - 1/4" - 20	2
19	193- 57	WASHER - 1/4" lock	2
	C 28962	CLIP - starter cable (80XE)	1

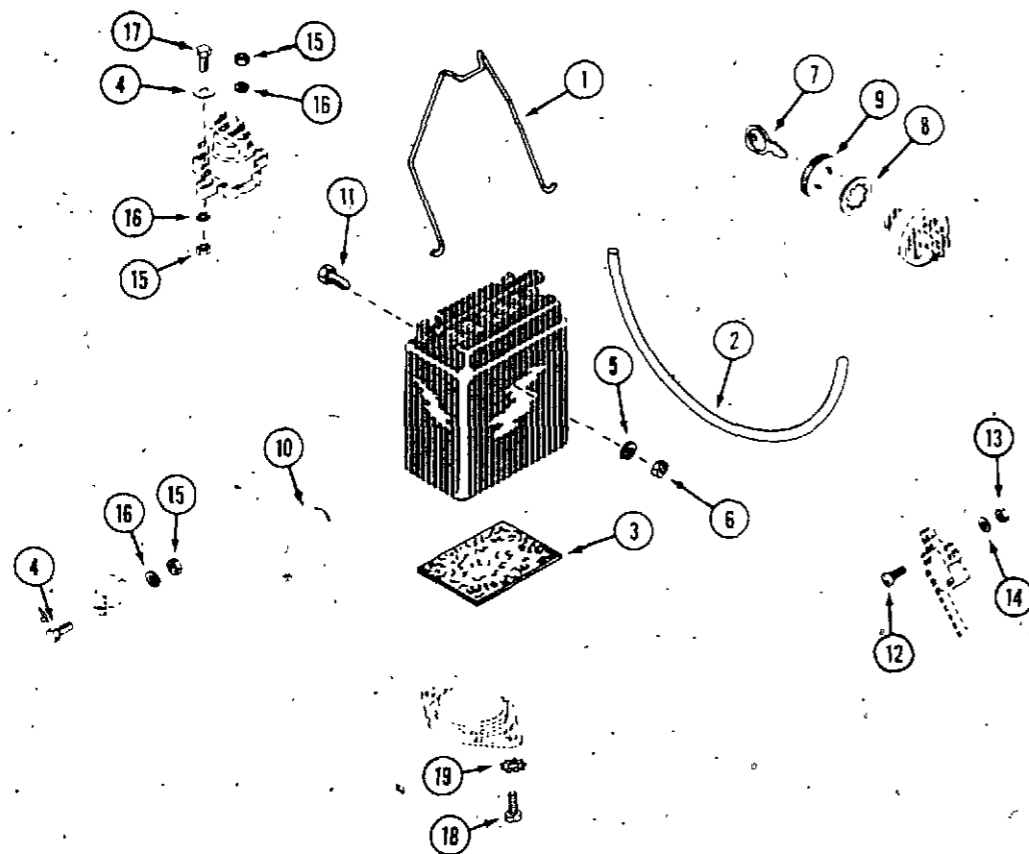

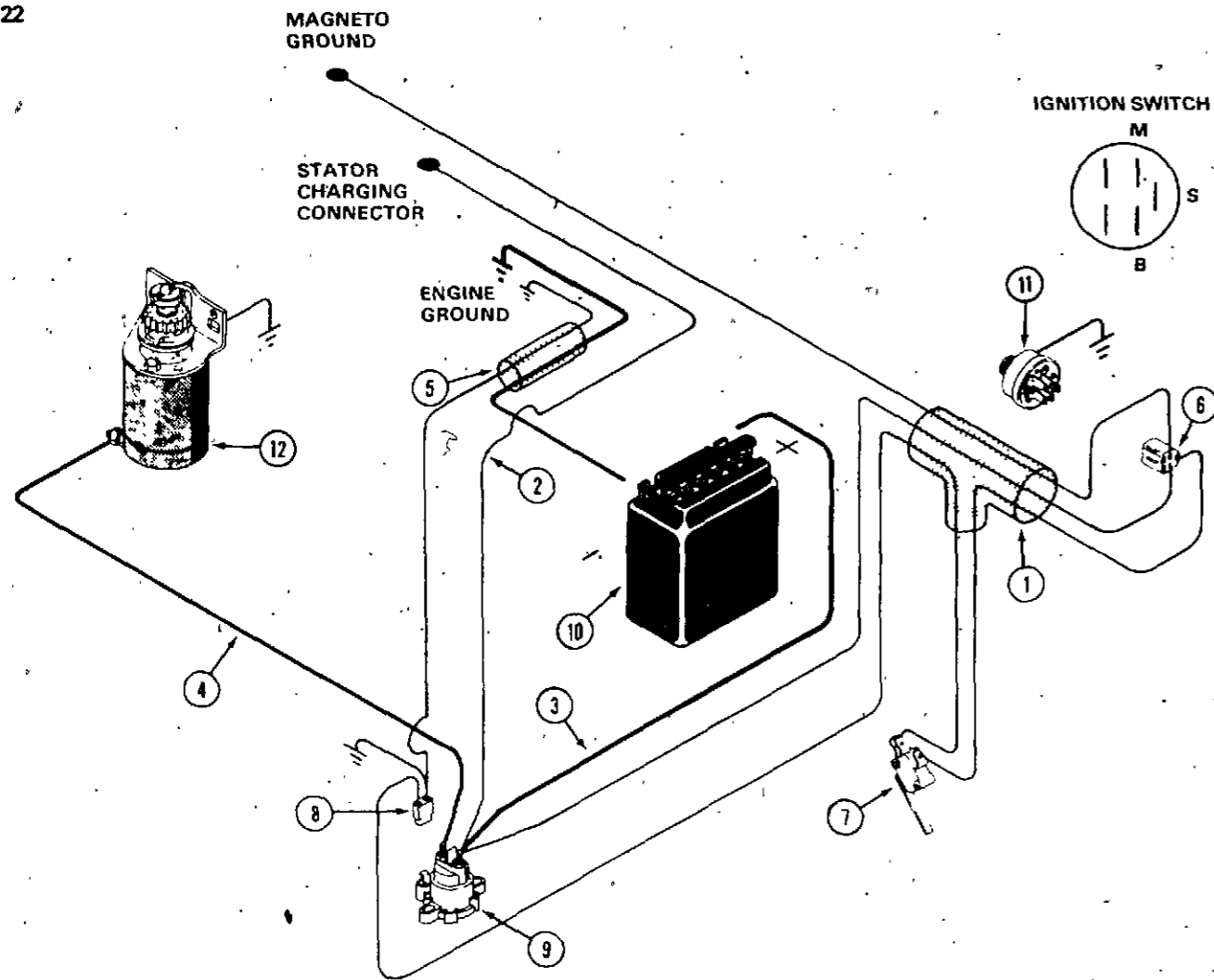

ELECTRICAL SYSTEM (80XC, 80XE)

Use before S/N:
80XC - 14115145
80XE - 14115785

REF.	PART NO.	DESCRIPTION,	REQ'D
1	C 27532	HARNES - wire (80XC)	1
1	C 29137	HARNES - wire (80XE)	1
2	C 27533	WIRE - solenoid to engine	1
	C 26142	HOUSING - socket	1
3	C 27521	CABLE - battery positive to solenoid	1
4	C 27534	CABLE - solenoid to starter	1
5	C 27541	HARNES - wire	1
6	C 24460	CONNECTOR - switch	1
7	C 26108	SWITCH - neutral start	1
8	C 27549	CONNECTOR - solenoid	1
9	C 27523	SOLENOID - start	1
10	C 26425	BATTERY - 12 volt (includes caps, vent hose and hardware)	1
	C 26426	CAP - battery	6
11	C 30267	SWITCH - ignition	1
12	C 27264	STARTER - engine, 12 volt	1

ELECTRICAL SYSTEM (80XM)

Use before S/N 14100555

1	C 30267	SWITCH - ignition	1
2	C 24460	CONNECTOR - switch	1
3	C 29118	SWITCH - interlock	1
4	C 29136	HARNES - wire	1
5	C 26108	SWITCH - neutral start	1

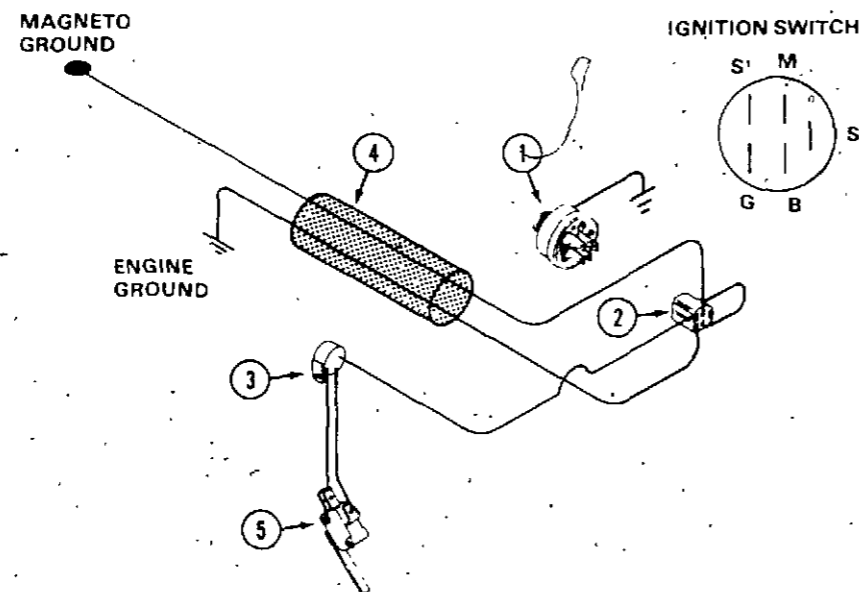

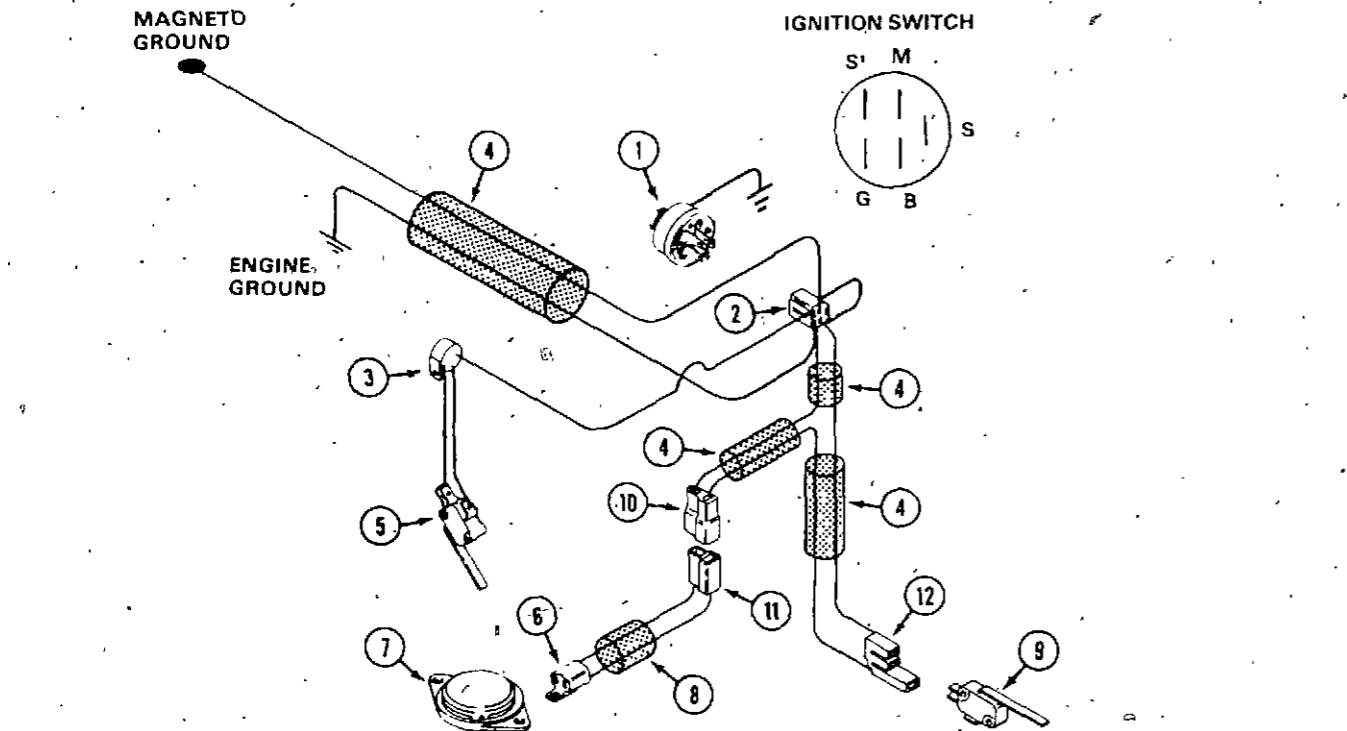
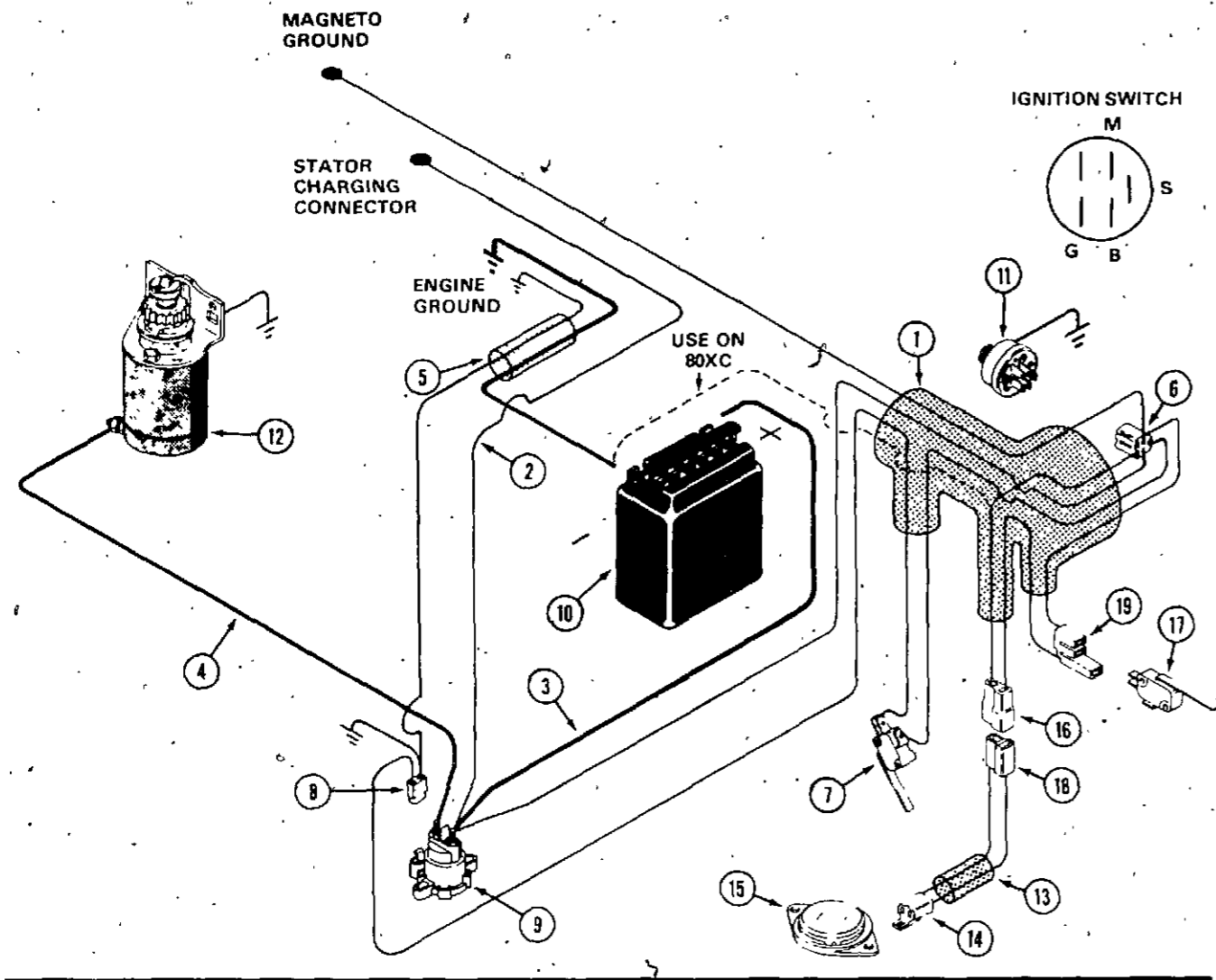

ELECTRICAL SYSTEM (80XC, 80XE)

Use S/N and after:
80XC - 14115145
80XE - 14115785

REF.	PART NO.	DESCRIPTION	REQ'D
1	C 30998	HARNESS - wire (80XC)	1
1	C 30999	HARNESS - wire (80XE)	1
2	C 27533	WIRE - solenoid to engine	1
	C 26142	HOUSING - socket	1
3	C 27521	CABLE - battery positive to solenoid	1
4	C 27534	CABLE - solenoid to starter	1
5	C 27541	HARNESS - wire	1
6	C 24460	CONNECTOR - switch	1
7	C 26108	SWITCH - neutral start	1
8	C 27549	CONNECTOR - solenoid	1
9	C 27523	SOLENOID - start	1
10	C 26425	BATTERY - 12 volt (includes caps, vent hose and hardware)	1
	C 26426	CAP - battery	6
11	C 30267	SWITCH - ignition	1
12	C 27264	STARTER - engine, 12 volt	1
13	C 31043	HARNESS - seat switch	1
14	C 30937	CONNECTOR - switch	1
15	C 30938	SWITCH - seat	1
16	C 25338	CONNECTOR - wire, female	1
17	C 30275	SWITCH - interlock	1
18	C 24813	CONNECTOR - wire, male	1
19	C 30279	CONNECTOR - wire	1

ELECTRICAL SYSTEM (80XM)

Use S/N 14100555 and after

1	C 30267	SWITCH - ignition	1
2	C 24460	CONNECTOR - switch	1
3	C 29118	SWITCH - interlock	1
4	C 31001	HARNESS - wire	1
5	C 26108	SWITCH - neutral start	1
6	C 30937	CONNECTOR - switch	1
7	C 30938	SWITCH - seat	1
8	C 31043	HARNESS - wire, seat switch	1
9	C 30275	SWITCH - interlock	1
10	C 25338	CONNECTOR - wire, female	1
11	C 24813	CONNECTOR - wire, male	1
12	C 30279	CONNECTOR - wire	1

INGERSOLL 8

80xc 18

INGERSOLL 19

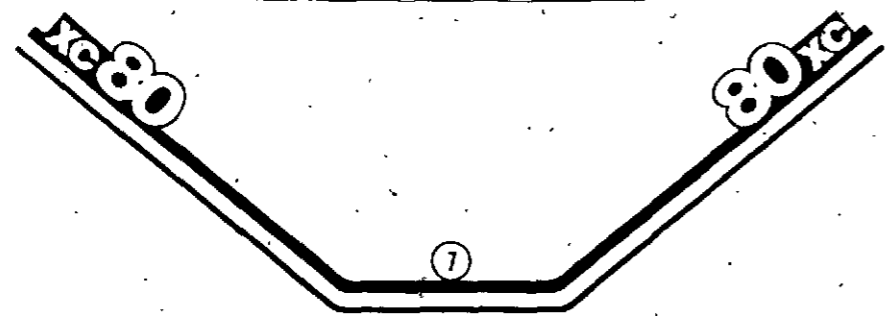
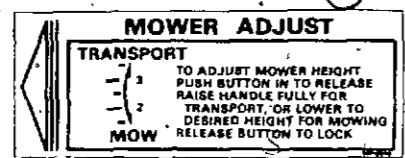
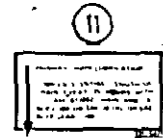
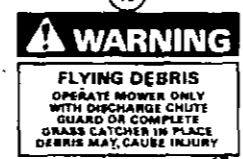
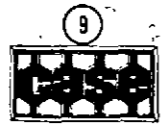
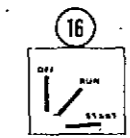
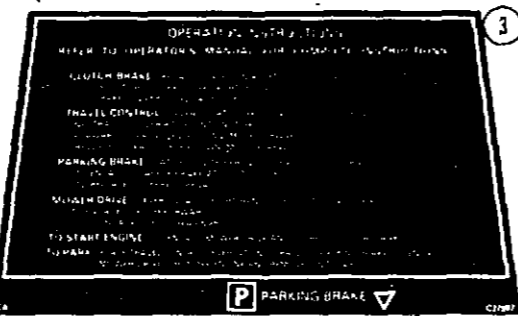
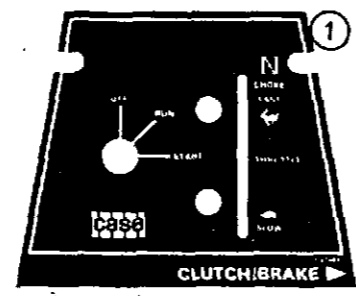

DECALS (English)

Use before S/N:
80XC - 14115145
80XE - 14115785
80XM - 14100555

REF.	PART NO.	DESCRIPTION	REQ'D
1	C 27961	DECAL - ignition and throttle (80XC)	1
2	C 29935	DECAL - "WARNING" (80XC)	1
3	C 27997	DECAL - operation (80XC)	1
4	C 29119	DECAL - mower height adjust	1
5	C 31087	DECAL - "DANGER" blade	1
6	C 12519	DECAL - "NO STEP"	1
7	C 27907	DECAL - tower, front (80XC) (shown)	1
7	C 29139	DECAL - tower front (80XE)	1
7	C 29140	DECAL - tower front (80XM)	1
8	C 27906	DECAL - engine enclosure R.H. (shown) (80XC)	1
8	C 27905	DECAL - engine enclosure L.H. (80XC)	1
9	321- 5040	MEDALLION - tower, front	1
10	C 31086	DECAL - "WARNING" flying debris	1
11	C 26936	DECAL - chain lubrication	1
12	C 27946	DECAL - crown	1
13	C 29934	DECAL - "WARNING" and operation (80XE, 80XM)	1
14	C 27875	DECAL - clutch, brake (80XE, 80XM)	1
15	C 29101	DECAL - throttle (80XE, 80XM)	1
16	C 29102	DECAL - ignition switch (80XE, 80XM)	1
17	C 27947	DECAL - engine enclosure, rear (80XC), yellow stripe	2
18	C 27948	DECAL - rear (80XC) (shown)	1
18	C 29120	DECAL - rear (80XE)	1
18	C 29121	DECAL - rear (80XM)	1
19	C 29142	DECAL - seat support L.H. (80XE, 80XM) (shown)	1
19	C 29143	DECAL - seat support R.H. (80XE, 80XM)	1

**DECALS (Bilingual)
(French and English)**

1	321- 4747	DECAL - ignition and throttle (80XC)	1
2	321- 4766	DECAL - "WARNING" (80XC)	1
3	C 26482	DECAL - operation (80XC)	1
4	321- 4755	DECAL - mower height adjust	1
5	321- 4763	DECAL - "CAUTION" blade	1
6	321- 4726	DECAL - "NO STEP"	1
9	C 29799	MEDALLION - tower, front	1
10	321- 6642	DECAL - "DANGER" flying debris	1
11	C 26937	DECAL - chain lubrication	1
12	C 26483	DECAL - crown	1

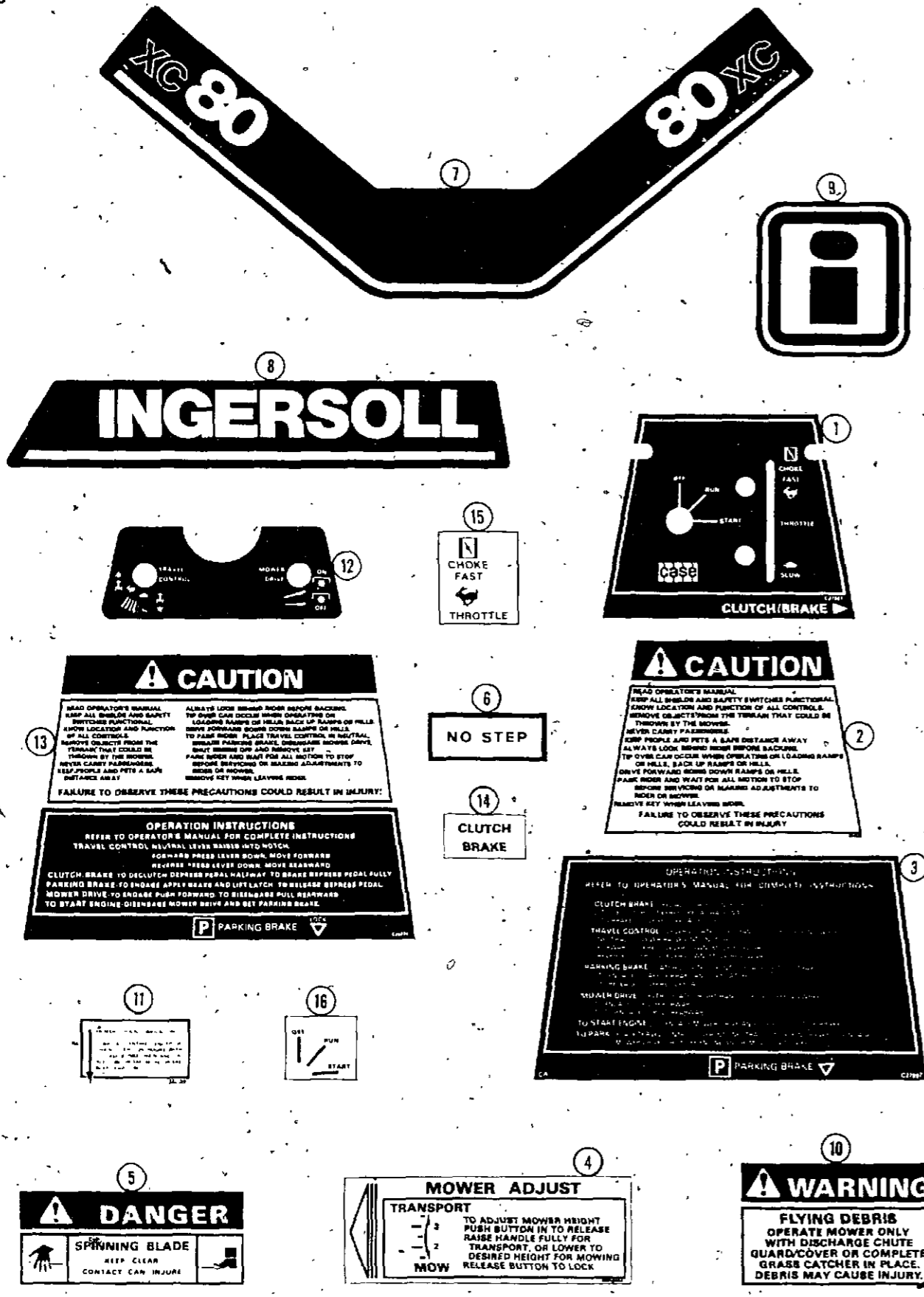

DECALS (English)

Use S/N and after:
 80XC - 14115145
 80XE - 14115785
 80XM - 14100555

REF.	PART NO.	DESCRIPTION	REQ'D
1	C 27961	DECAL - ignition and throttle (80XC)	1
2	C 29935	DECAL - "CAUTION"	1
3	C 27997	DECAL - operation (80XC)	1
4	C 29119	DECAL - mower height adjust	1
5	C 31087	DECAL - "DANGER" blade	1
6	C 12519	DECAL - "NO STEP"	1
7	C 30979	DECAL - tower front (80XC) (shown)	1
7	C 30980	DECAL - tower front (80XE)	1
7	C 30981	DECAL - tower front (80XM)	1
8	C 30984	DECAL - engine enclosure R.H. (shown) (80XC)	1
8	C 30983	DECAL - engine enclosure L.H. (80XC)	1
8	C 30985	DECAL - seat support L.H. (80XE, 80XM)	1
8	C 30986	DECAL - seat support R.H. (80XE, 80XM)	1
9	C 30539	MEDALLION - tower front	1
10	C 31086	DECAL - "WARNING" flying debris	1
11	C 26936	DECAL - chain lubrication	1
12	C 27946	DECAL - crown	1
13	C 29934	DECAL - "CAUTION" and operation (80XE, 80XM)	1
14	C 27875	DECAL - clutch, brake (80XE, 80XM)	1
15	C 30987	DECAL - throttle (80XE, 80XM)	1
16	C 29102	DECAL - ignition switch (80XE, 80XM)	1

**DECALS (Bilingual)
(French and English)**

1	321- 4747	DECAL - ignition and throttle (80XC)	1
2	321- 4766	DECAL - "WARNING" (80XC)	1
3	C 26482	DECAL - operation (80XC)	1
4	321- 4755	DECAL - mower height adjust	1
5	321- 4763	DECAL - "CAUTION" blade	1
6	321- 4726	DECAL - "NO STEP"	1
9	C 29799	MEDALLION - tower, front	1
10	321- 6642	DECAL - "DANGER" flying debris	1
11	C 26937	DECAL - chain lubrication	1
12	C 26483	DECAL - crown	1

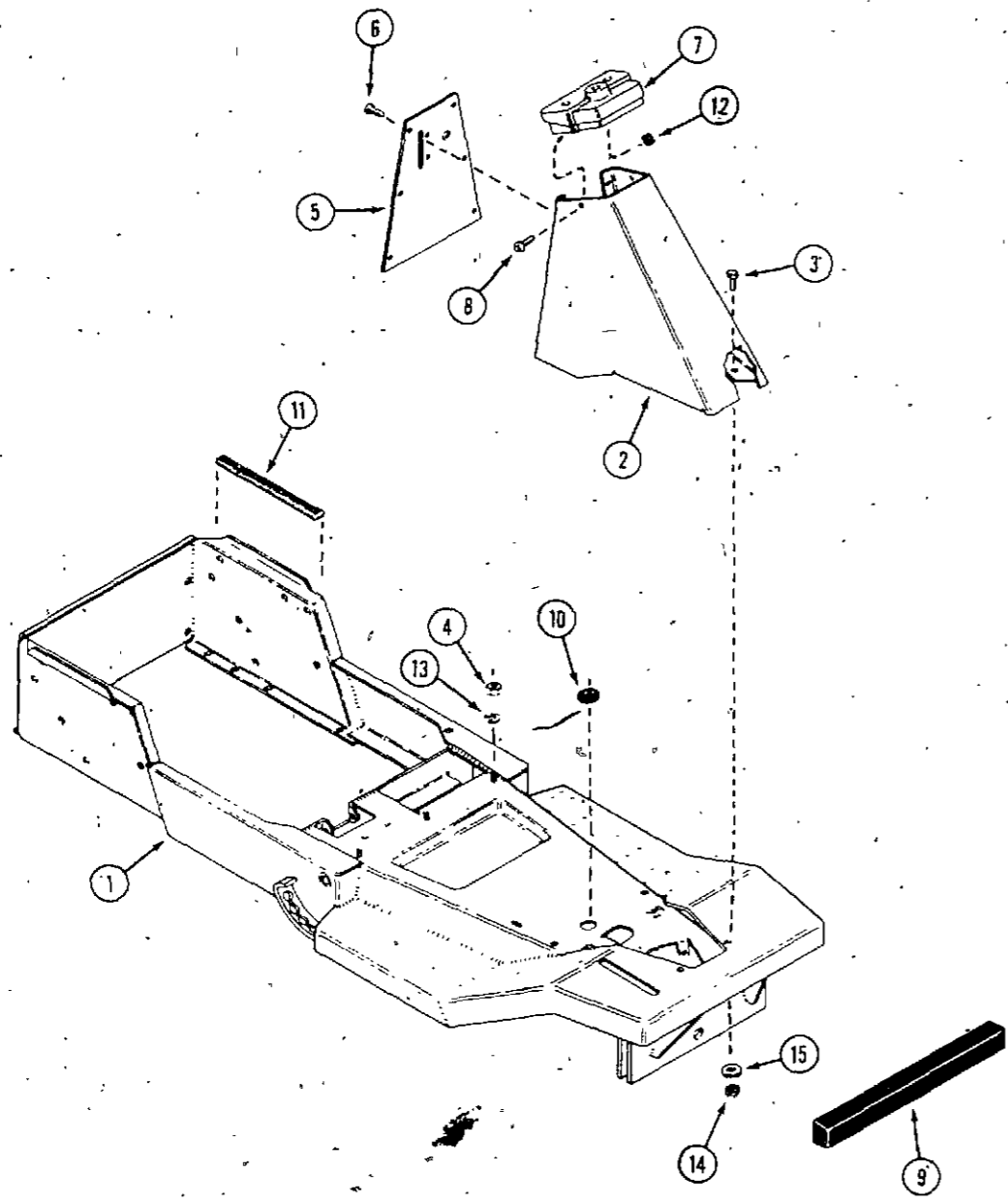

FRAME AND CONTROL TOWER (80XC)

REF.	PART NO.	DESCRIPTION	REQ'D
1	C 30989	FRAME - main	1
2	C 23349	TOWER - control	1
3	113- 2	BOLT - 1/4" - 20 x 5/8"	4
4	129- 101	NUT - 1/4" - 20	3
6	C 23351	PANEL - instrument	1
6	187- 1334	SCREW - #8 x 1/2" phillips head	6
7	C 25548	CROWN - tower	1
8	182- 559	SCREW - #10 - 24 x 3/4" phillips	2
9	C 29123	BUMPER - front, rubber	1
10	C 28807	GROMMET - rubber	1
11	C 24529	CUSHION - rear enclosure	2
12	131- 67	NUT - lock #10 - 24 hex	4
13	192- 19	LOCKWASHER - 1/4"	3
14	131- 934	NUT - lock 1/4" - 20	4
15	195- 518	WASHER - 1/4"	4

FRAME AND CONTROL TOWER (80XE, 80XM)

REF.	PART NO.	DESCRIPTION	REQ'D
1	C 30990	FRAME - main	1
2	C 29093	TOWER - control	1
3	113- 2	BOLT - 1/4" - 20 x 5/8"	4
3	121- 106	BOLT - 5/16" - 18 x 1/2"	4
4	131- 911	NUT - lock 5/16" - 18	4
4	131- 934	NUT - lock 1/4" - 20	4
5	C 29132	PANEL - tower	1
6	187- 1334	SCREW - #8 x 1/2" phillips	6
7	C 25548	CROWN - tower	1
8	182- 559	SCREW - #10 x 3/4" phillips	2
9	131- 67	NUT - lock #10	2
10	195- 518	WASHER - 1/4"	4
11	C 29146	TRIM - frame 13-3/8" (340 mm)	1
12	C 29147	TRIM - seat support 1-1/4" (32 mm)	2

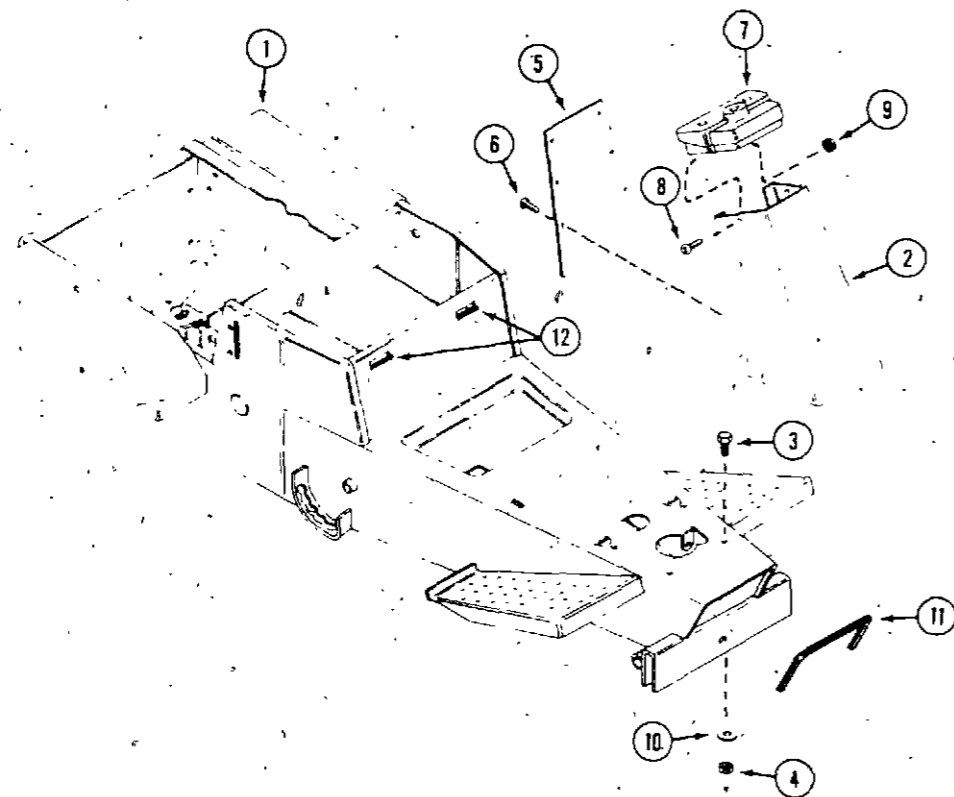

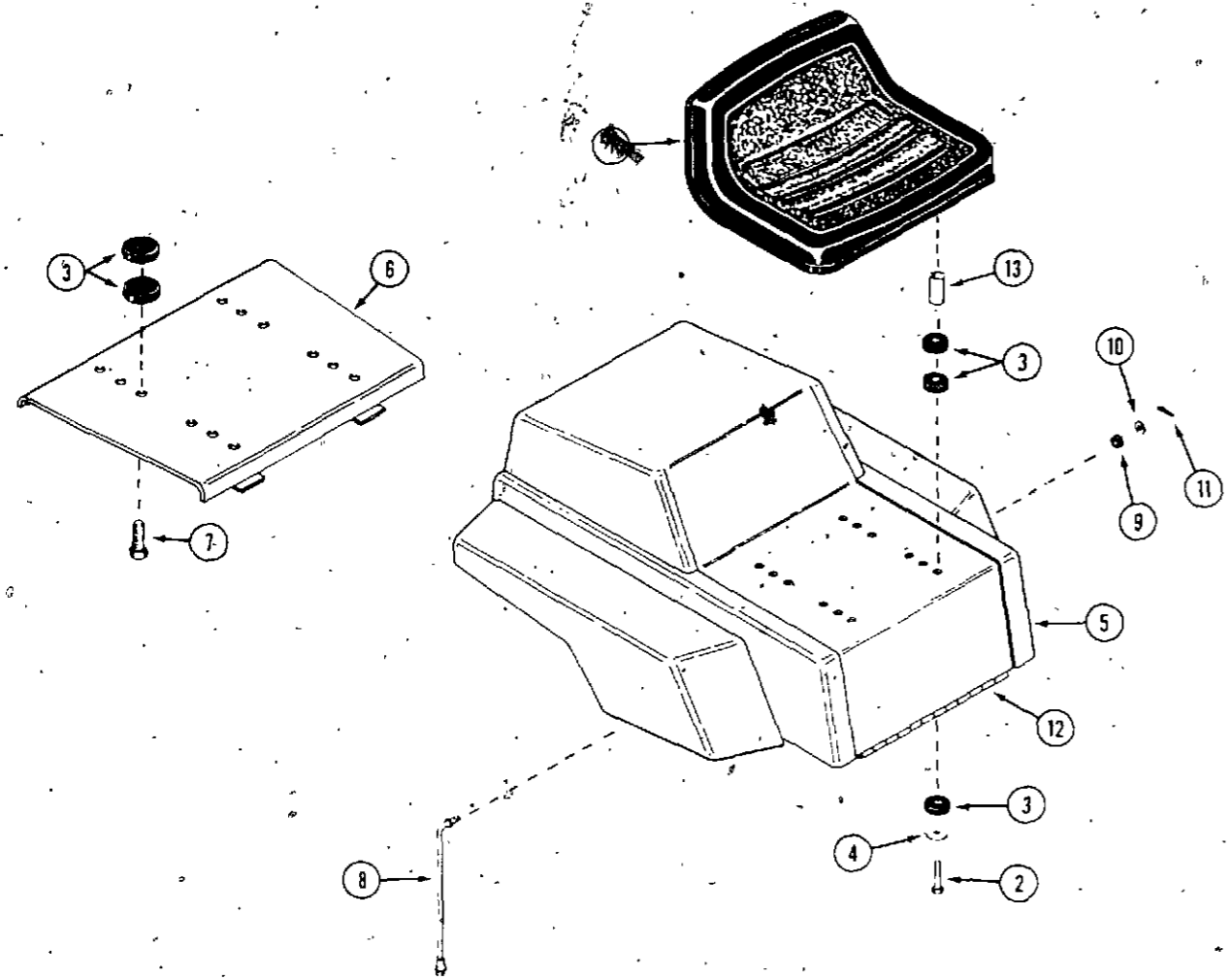

SEAT AND REAR ENGINE ENCLOSURE

REF	PART NO.	DESCRIPTION	REQ'D
1	C 31280	SEAT - black	1
2	113- 120*	BOLT - 5/16" - 18 x 1-3/4" (80XC)	4
2	113- 110**	BOLT - 5/16" - 18 x 2-1/4 (80XC)	4
3	C 15410	CUSHION - rubber, seat	UAR
4	195- 2175	WASHER - 5/16" I.D. x 1-1/4" O.D. (80XC)	4
5	C 31229	ENCLOSURE - engine, rear (80XC)	1
6	C 30993	SUPPORT - seat (80XE, 80XM)	1
7	113- 122*	BOLT - 5/16" - 18 x 1-1/2 (80XE, 80XM)	4
7	113- 121**	BOLT - 5/16" - 18 x 2" (80XE, 80XM)	4
8	C 24562	ROD - prop, enclosure (80XC)	1
9	C 24574	BUSHING - rod, (80XC)	1
10	195- 518	WASHER - 9/32" I.D. x 5/8" O.D.	1
11	132- 378	PIN - cotter 1/16" x 1"	1
12	C 24091	HINGE - enclosure (80XC)	1
13	C 22023*	SPACER	4

*Use before S/N:

**Use S/N and after:

80XC - 14115145

80XE - 14115785

80XM - 14100555

FRONT AND REAR WHEELS

1	C 30908	WHEEL - front assembly	2
2	C 24503	BUSHING - wheel	2
3	219- .10	FITTING - lube 1/4" - 28 taper	1
4	C 26526	CAP - hub, plastic	4
5	C 30910	WHEEL - rear	2

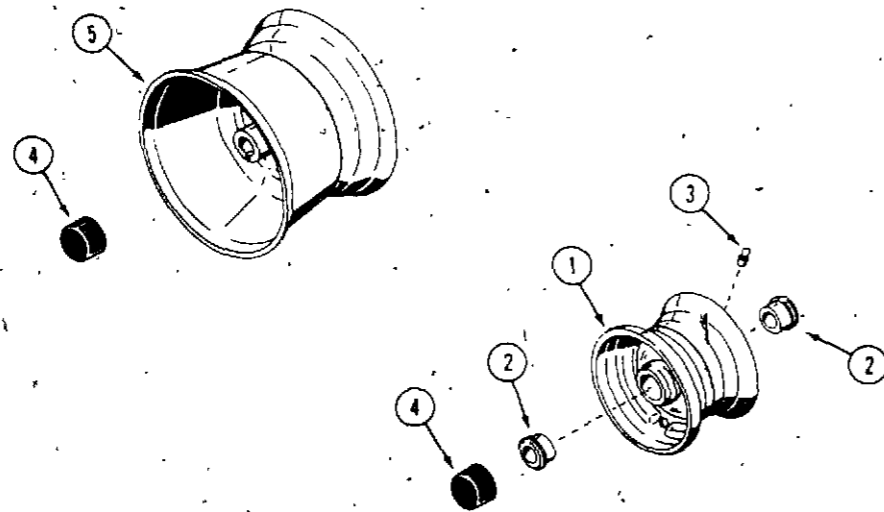

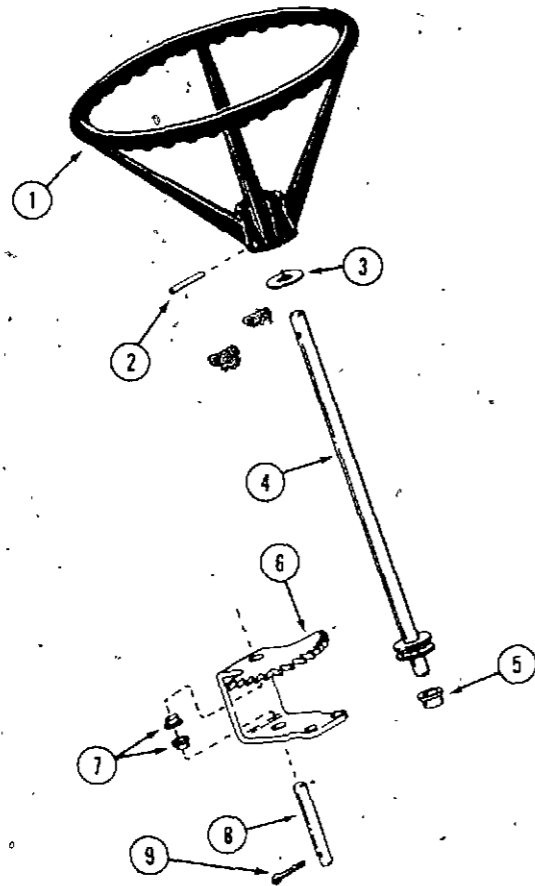

STEERING ASSEMBLY

REF.	PART NO.	DESCRIPTION	REQ'D.
1	C 24100	WHEEL - steering	1
2	138- 143	PIN - steering wheel to shaft	1
3	195- 541	WASHER - 3/8"	4
4	C 24189	SHAFT - steering	1
5	C 27501	BUSHING - flange, bronze	1
6	C 24179	GEAR - sector, steering	1
7	C 24182	BUSHING - flange, bronze	2
8	C 24200	PIN - pivot, sector gear (service part)	1
9	132- 49	PIN - cotter 1/8" x 1-1/8"	1

FRONT AXLE

1	C 24178	AXLE - front	1
2	C 28646	BUSHING - axle pivot	1
3	113- 410	BOLT - 1/2" - 13 x 1-1/2"	1
4	131- 1182	NUT - lock 1/2" - 13 hex	1
5	C 25846	BUSHING - flange	4
6	C 28226	WASHER	4
7	C 27893	SPINDLE - left hand	1
7	C 27894	SPINDLE - right hand (shown)	1
8	C 26333	BALLJOINT - L.H. thread	2
9	C 26332	BALLJOINT - R.H. thread	2
10	129- 289	NUT - jam 3/8" - 24 hex, L.H. thread	2
11	129- 163	NUT - jam 3/8" - 24 hex	2
12	113- 208	BOLT - 3/8" - 16 x 1-1/4"	4
13	131- 1181	NUT - lock 3/8" - 16 hex	4
14	C 23964	TIE ROD	2
15	C 28232	RING - retaining	4

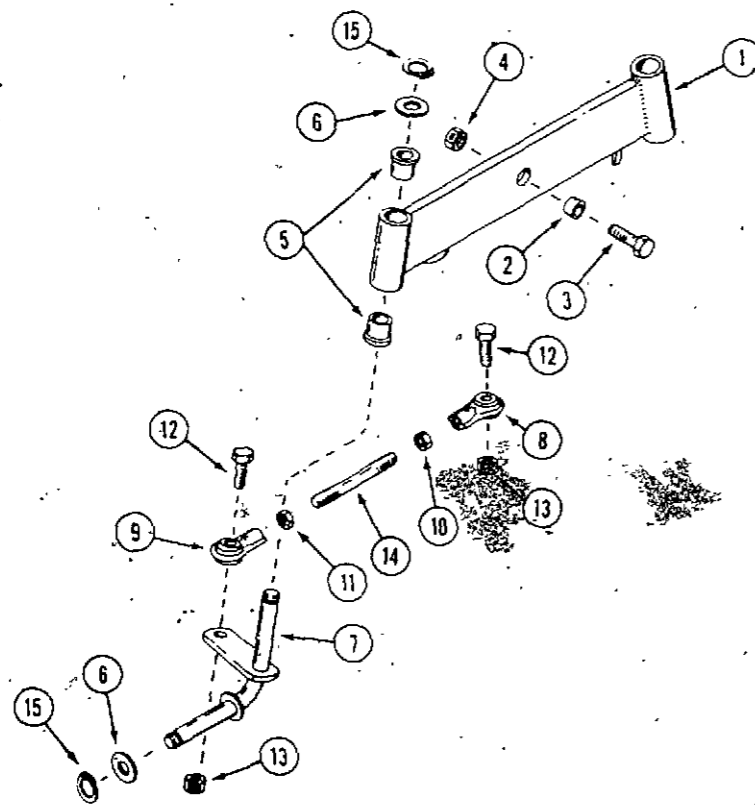

TRAVEL CONTROL

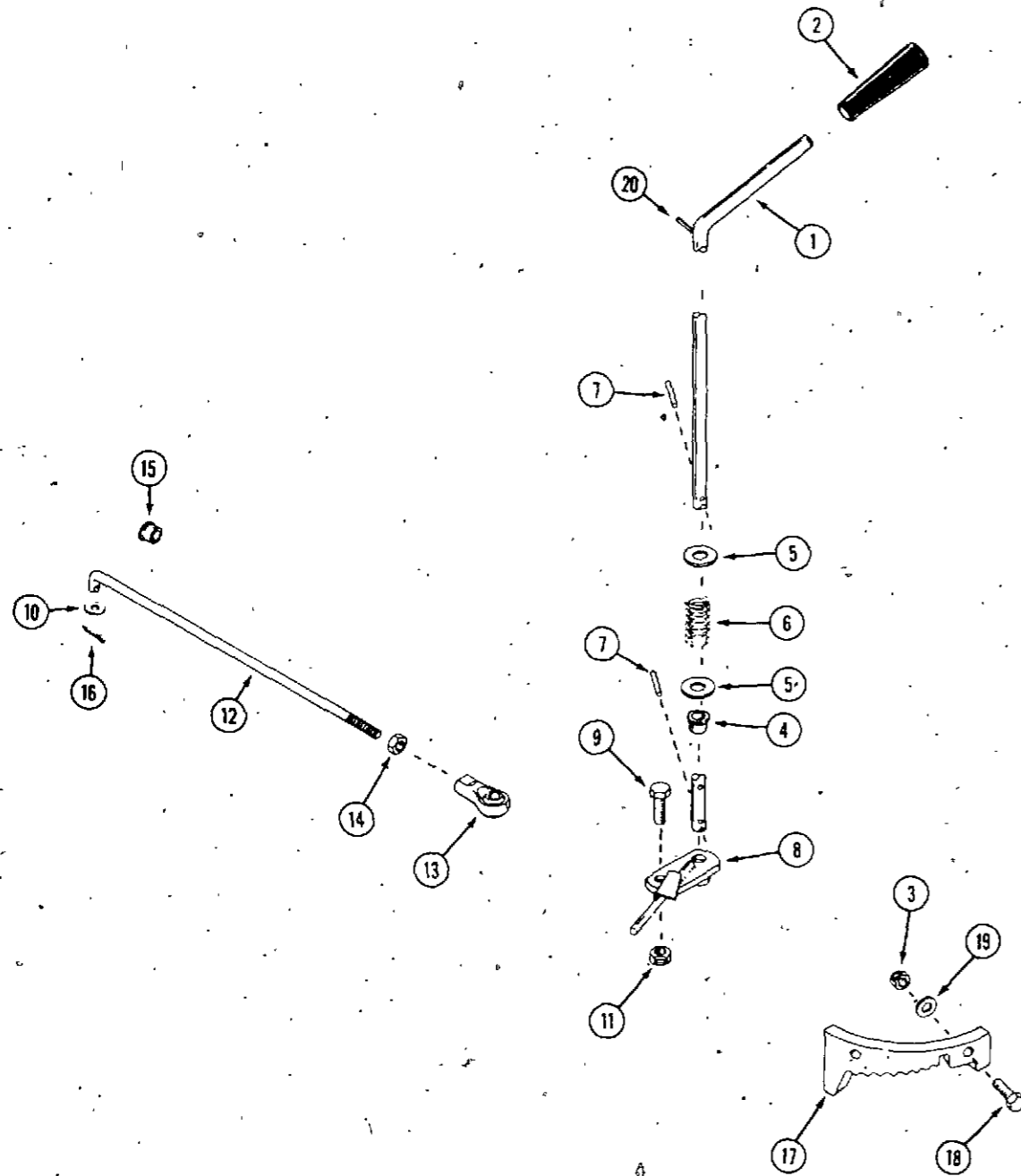

REF.	PART NO.	DESCRIPTION	REQ'D
1	C 29260	LEVER - travel control (80XC)	1
1	C 29148	LEVER - travel control (80XE, 80XM)	1
2	C 29047	KNOB - travel control lever	1
3	131- 176	NUT - lock 5/16" - 18 hex	2
4	C 25229	BEARING - flange	1
5	195- 533	WASHER	2
6	C 24669	SPRING - control lever	1
7	138- 2071	PIN - roll 3/16" x 1"	2
8	C 24165	ARM - travel control (service part)	1
9	113- 208	BOLT - 3/8" - 16 x 1-1/4" hex	1
10	195- 104	WASHER - 1" O.D.	2
11	131- 1181	NUT - lock 3/8" - 16 hex	1
12	C 29116	ROD - control (arm to pivot plate)	2
13	C 26332	BALLJOINT - control rod, R.H. tread	2
14	129- 163	NUT - jam 3/8" - 24 hex	1
15	C 20093	BUSHING - fliplock	1
16	132- 321	PIN - cotter 3/32" x 1"	2
17	C 24401	LOCATOR - travel control	1
18	113- 103	BOLT - 5/16" - 18 x 1" hex	2
19	195- 521	WASHER - 5/16"	2
20	138 2073	PIN - spiral	1

TRANSMISSION DRIVE PIVOT

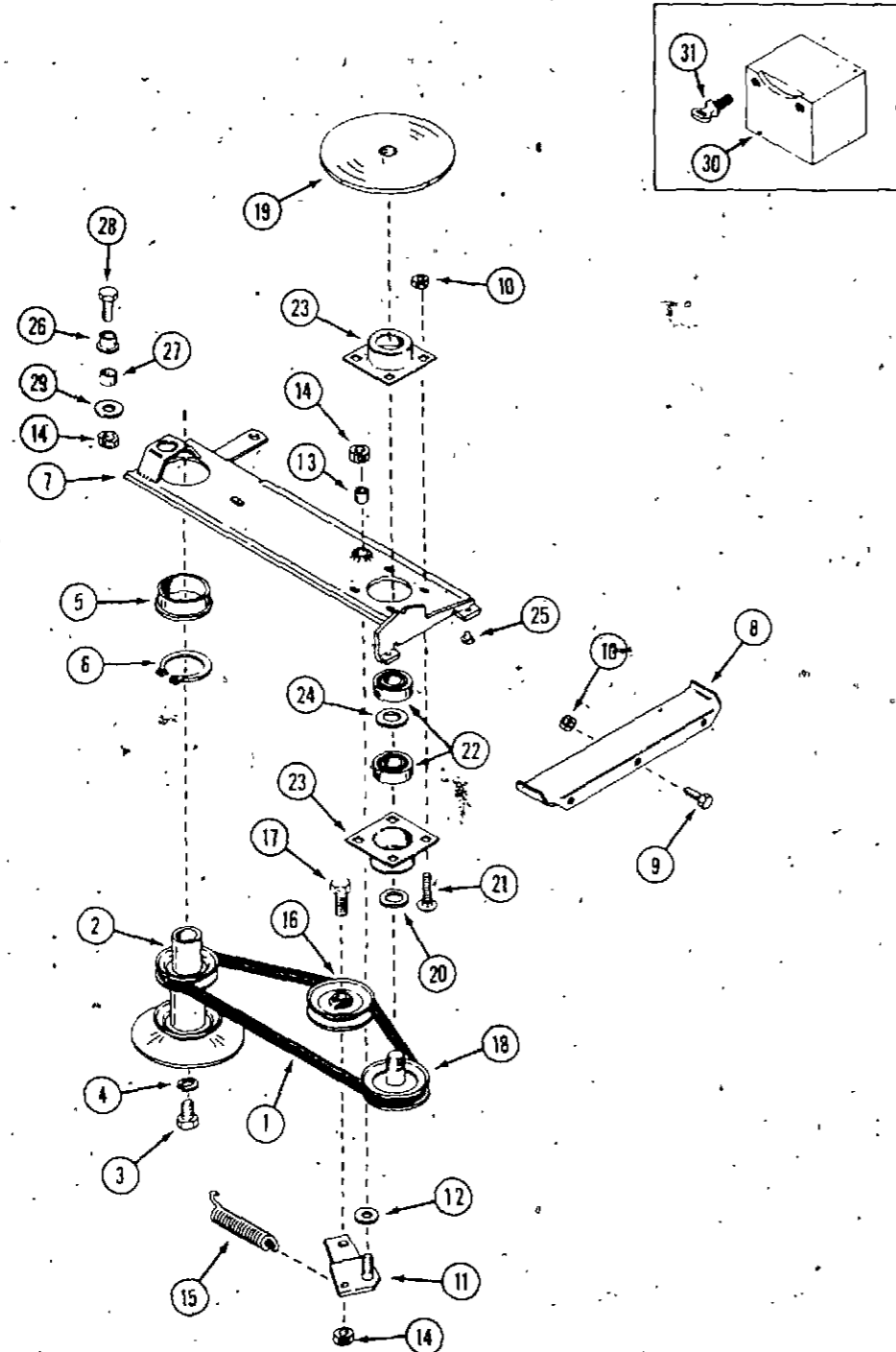

REF.	PART NO.	DESCRIPTION	REQ'D
1	C 24342	BELT - traction drive	1
2	C 23765	PULLEY - engine	1
3	14- 712	BOLT - 7/16" - 20 x 3/4" hex	1
4	192- 22	LOCKWASHER - 7/16"	1
5	C 27984	BUSHING - flange (80XC)	1
6	C 28261	SNAP RING - external (80XC)	1
7	C 29163	PLATE - pivot (80XE, 80XM) (shown)	1
7	C 29164	PLATE - pivot (80XC)	1
8	C 24160	PLATE - slide, pivot plate (80XC)	1
9	113- 118	BOLT - 5/16" - 18 x 5/8" hex	3
10	131- 176	NUT - lock 5/16" - 18 hex	7
11	C 22931	ARM - idler	1
12	195- 522	WASHER - 3/8"	1
13	C 17203	BUSHING - sleeve	1
14	131- 1181	NUT - lock 3/8" - 16 hex	3
15	C 24321	SPRING - idler arm	1
16	C 17213	PULLEY - idler, "V" belt	1
17	113- 209	BOLT - 3/8" - 16 x 1-1/2" hex	1
18	C 24128	PULLEY AND SHAFT ASSEMBLY - disc drive	1
19	C 24193	DISC - friction drive	1
20	C 12975	WASHER	1
21	111- 132	BOLT - 5/16" x 3/4" round head, square neck	4
22	C 28971	BEARING - roller	2
23	C 23818	FLANGETTE	2
24	C 28226	WASHER	1
25	C 26458	BUTTON - slide	2
26	C 27501	BUSHING - flange (80XE, 80XM)	1
27	C 29106	SPACER - pivot (80XE, 80XM)	1
28	113- 208	BOLT - 3/8" - 16 x 1-1/4" (80XE, 80XM)	1
29	195- 104	WASHER - flat (80XE, 80XM)	1
30	C 29879	BLOCK - gauge (friction disc to drive wheel alignment)	1
31	C 29774	SCREW - thumb	2

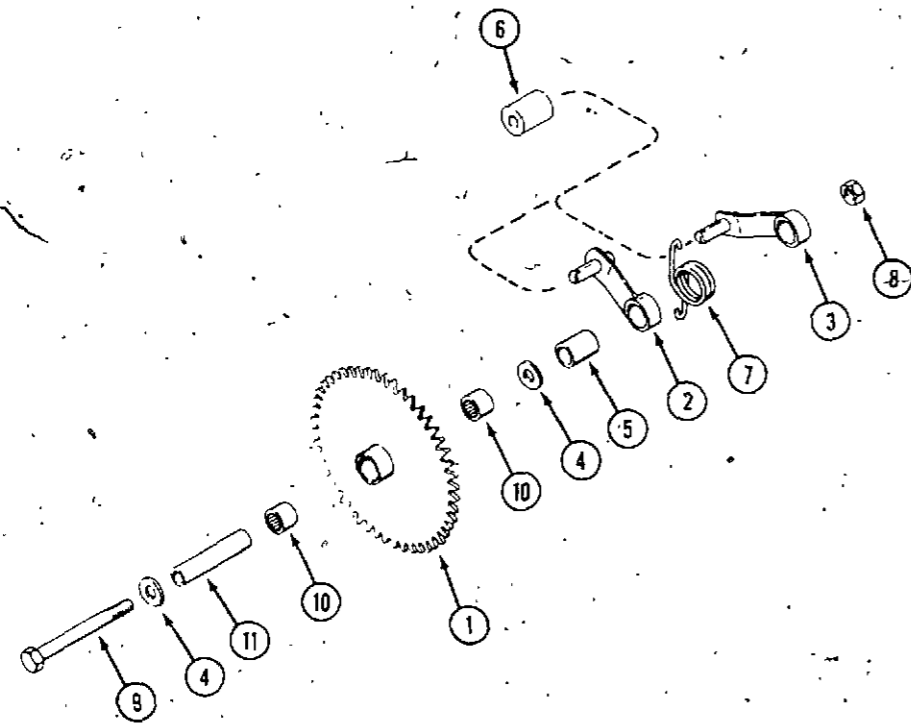

**JACKSHAFT ASSEMBLY
(INTERMEDIATE DRIVE)**

REF.	PART NO.	DESCRIPTION	REQ'D
1	C 25087	SPROCKET ASSEMBLY - intermediate drive (dual sprocket)	1
2	C 26886	ARM - idler (upper)	1
3	C 26887	ARM - idler (lower)	1
4	C 28286	WASHER - shim	2
5	C 25091	BUSHING - sleeve	1
6	C 26862	ROLLER - idler	2
7	C 24225	SPRING - torsion, idler arms	1
8	131- 1181	NUT - lock 3/8" - 16 hex	1
9	113- 252	BOLT - 3/8" - 16 x 3-3/4" hex	1
10	C 25092	BEARING - 9/16" bore	1
11	C 25093	SPACER - bearing race	1

**DRIVE SHAFT ASSEMBLY
(PRIMARY DRIVE)**

1	C 26130	SHAFT - primary drive	1
2	C 22891	WHEEL - friction drive	1
3	C 26129	SPACER - rolled	1
4	113- 102	BOLT - 5/16" - 18 x 3/4" hex	5
5	131- 176	NUT - lock 5/16" - 18 hex	5
6	C 25095	SPROCKET - drive	1
7	C 25097	SPACER - short	1
8	C 25098	SPACER - long	1
9	113- 205	BOLT - 3/8" - 16 x 5/8" hex	1
10	C 28263	WASHER	1
11	C 28971	BEARING - 3/4" bore	2
12	C 23818	FLANGETTE - bearing	1
13	111- 217	BOLT - 5/16" - 18 x 5/8" round head, square neck	4
14	131- 176	NUT - lock 5/16" - 18 hex	4

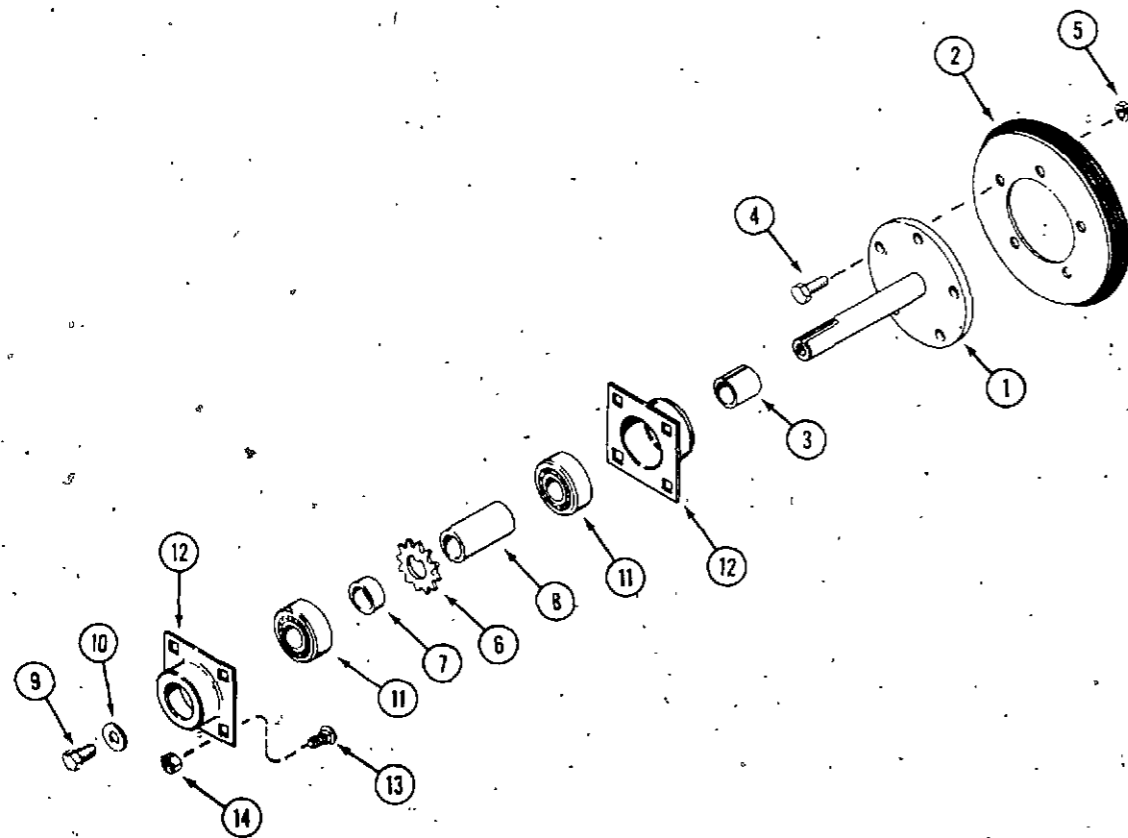

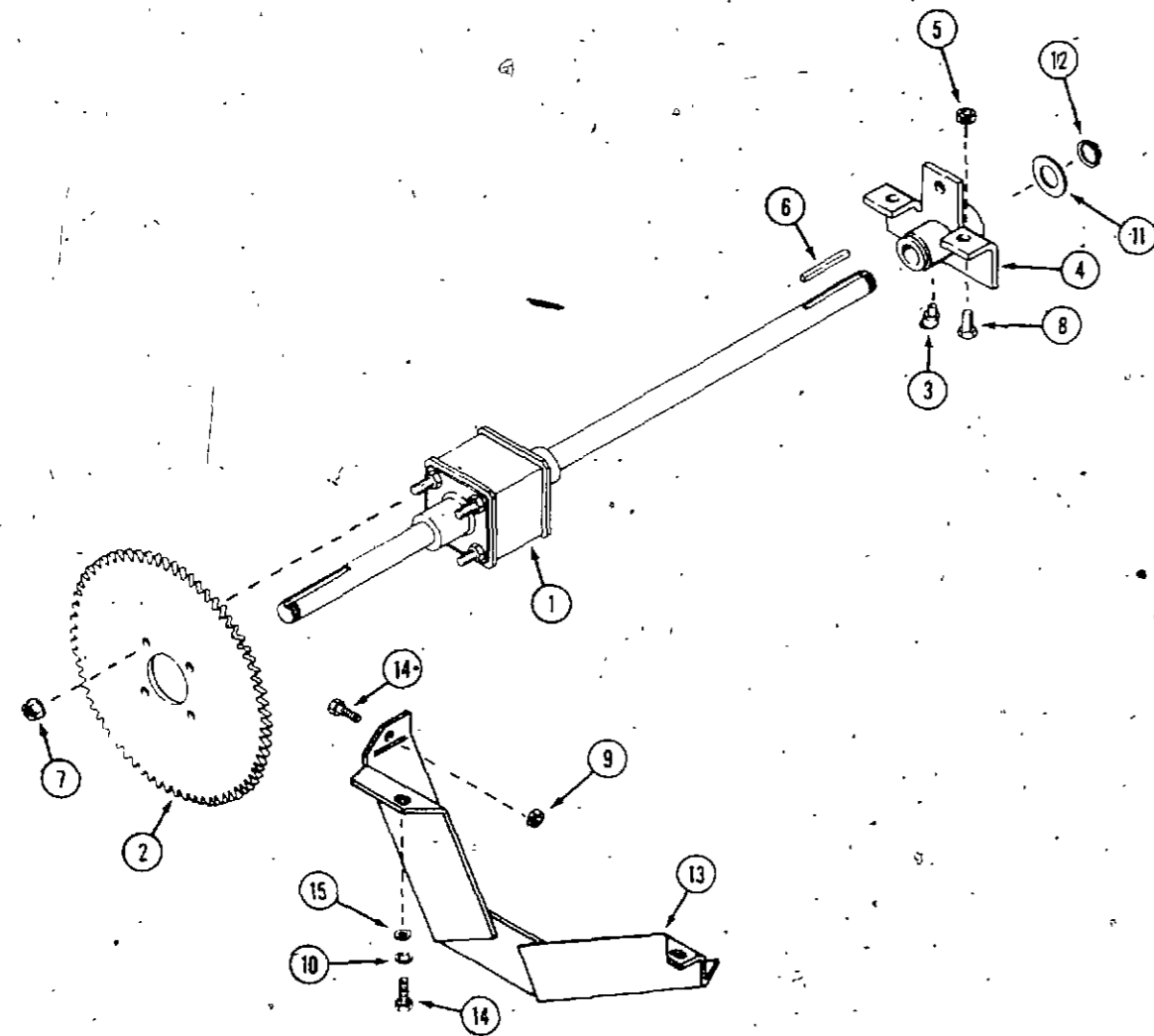

REAR AXLE

REF.	PART NO.	DESCRIPTION	REQ'D
1	C 26730	DIFFERENTIAL ASSEMBLY	1
	C 29920	GEAR CASE - includes gears	1
	C 29921	END CAP - includes bearing	2
	C 29922	AXLE - short, R.H.	1
	C 29923	AXLE - long, L.H.	1
	113- 138	BOLT - 5/16" - 18 x 3-1/2"	4
	129- 102	NUT - 5/16" - 18	4
2	C 26729	SPROCKET - drive, differential	1
3	219- 404	FITTING - lubrication, 45°	2
4	C 25200	BEARING AND RETAINER ASSEMBLY	2
5	131- 176	NUT - lock 5/16" - 18 hex	6
6	C 11796	KEY - 3/16" square x 2"	2
7	131- 911	NUT - flange lock 5/16" - 18 hex	4
8	113- 118	BOLT - 5/16" - 18 x 5/8"	6
9	131- 1102	NUT - 1/4" - 20 hex lock	1
10	192- 19	LOCKWASHER - 1/4"	2
11	C 28226	WASHER - spacer	UAR
12	C 28808	RING - snap	2
13	C 29141	GUARD - chain	1
14	113- 1	BOLT - 1/4" - 20 x 1/2" hex	3
15	195- 518	WASHER - 1/4"	2

DRIVE CHAIN

1	C 24343	CHAIN - #35 (primary drive to intermediate drive) 56 pitches	1
2	C 25094	CHAIN - #35 (intermediate drive to rear axle) 106 pitches	1
3	C 28645	CONNECTOR LINK - #35	2

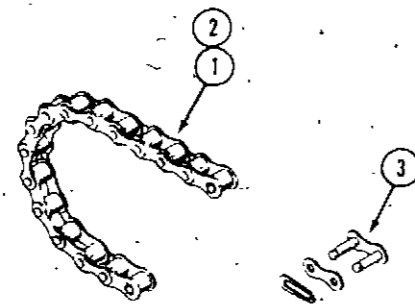

CLUTCH AND BRAKE

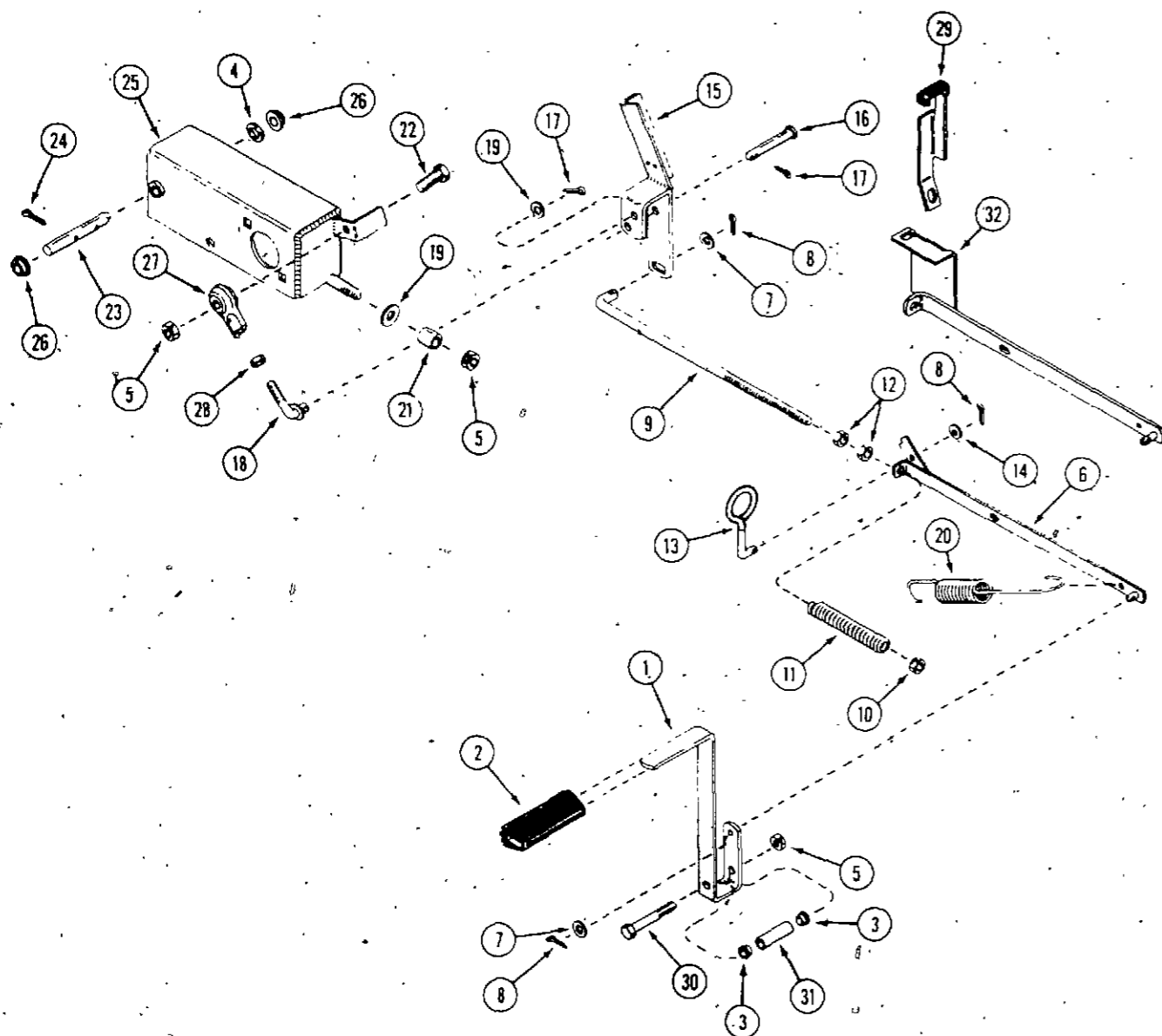

REF.	PART NO.	DESCRIPTION	REQ'D
1	C 24112	LEVER - clutch/brake assembly	1
2	C 24345	PAD - foot, rubber	1
3	C 26266	BUSHING - flange, nylon (press into chassis)	2
4	C 28806	WASHER - shim	UAR
5	131- 1181	NUT - lock 3/8" - 16 hex	3
6	C 24551	BRACKET - parking brake (80XC)	1
7	195- 518	WASHER - 1/4"	2
8	132- 6	PIN - cotter 1/16" x 5/8"	3
9	C 24753	ROD - brake adjust	1
10	131- 1102	NUT - lock 1/4" - 20 hex	1
11	C 24565	SPRING - brake rod	1
12	129- 101	NUT - 1/4" - 20 hex	2
13	C 24568	HANDLE - parking brake (80XC)	1
14	195- 513	WASHER - 3/16"	1
15	C 24749	ARM - brake (service part)	1
16	C 28266	PIN - clevis	1
17	132- 310	PIN - cotter 1/8" x 1"	3
18	C 25555	LINK - clutch	1
19	195- 525	WASHER - 3/8"	3
20	C 16379	SPRING - brake return	1
21	C 12045	SLEEVE - roller	1
22	113- 209	BOLT - 3/8" - 16 x 1-1/2"	1
23	C 24200	PIN - pivot	1
24	132- 49	PIN - cotter 1/8" x 1-1/8"	1
25	C 25083	HOUSING - chain and gears (service part)	1
26	C 24182	BUSHING - flange	2
27	C 26332	BALLJOINT	1
28	129- 163	NUT - jam 3/8" - 24 hex	1
29	C 29151	LATCH - brake (80XE, 80XM)	1
30	113- 248	BOLT - 3/8" - 16 x 2-3/4"	1
31	C 26848	SPACER - bushing 1/2" x 2"	1
32	C 29153	BRACKET - parking brake (80XE, 80XM)	1

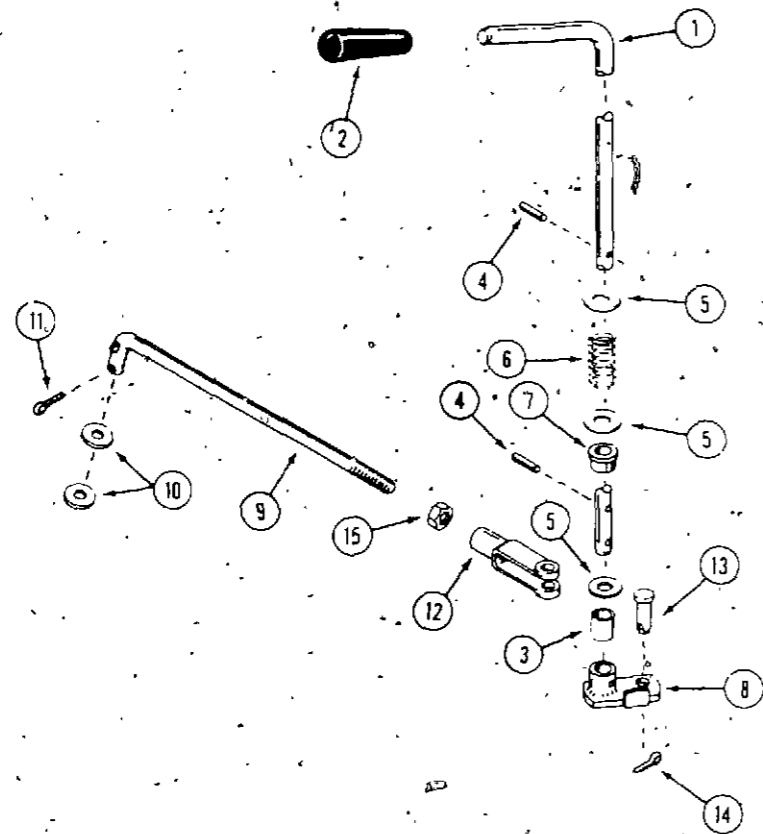

MODEL 80XC, 80XE AND 80XM RIDING LAWMOWER

MOWER DRIVE CONTROL

REF.	PART NO.	DESCRIPTION	REQ'D
1	C 29260	LEVER - mower drive (80XC) (shown)	1
1	C 29148	LEVER - mower drive (80XE, 80XM)	1
2	C 29046	KNOB - lever, mower drive	1
3	C 29104	SPACER - lever (80XE, 80XM)	1
4	138 2071	PIN - roll 3/16" x 15/16"	2
5	195- 533	WASHER - 1/2"	3
6	C 24669	SPRING - return	1
7	C 25229	BEARING - flange	1
8	C 24170	ARM - control, rod (service part)	1
9	C 24684	ROD - control	1
10	195- 525	WASHER - 3/8"	4
11	132- 310	PIN - cotter 1/8" x 1"	2
12	C 28978	CLEVIS - 3/8"	1
13	141- 4	PIN - clevis	1
14	132- 321	PIN - cotter 3/32" x 1"	1
15	129- 163	NUT - jam 3/8" - 24 hex	1

MOWER HEIGHT AND LIFT CONTROL

1	C 29091	ROD - push	1
2	C 29092	SPACER - lift	1
3	195- 2063	WASHER	UAR
4	C 15564	SPRING - return	1
5	C 14525	BUTTON - push	1
6	131- 1181	NUT - lock 3/8" - 16 hex	4
7	C 29086	SHAFT - lift pivot (80XC)	1
7	C 29087	SHAFT - lift pivot (80XE, 80XM)	1
8	C 24528	ARM - lift (L.H. side mounts in reverse)	2
9	138- 2071	PIN - spirol	2
10	C 24522	LINK - lift	2
11	195- 525	WASHER - 3/8"	4
12	132- 310	PIN - cotter 1/8" x 1"	4
13	C 24314	BOLT - "J" link adjust	2

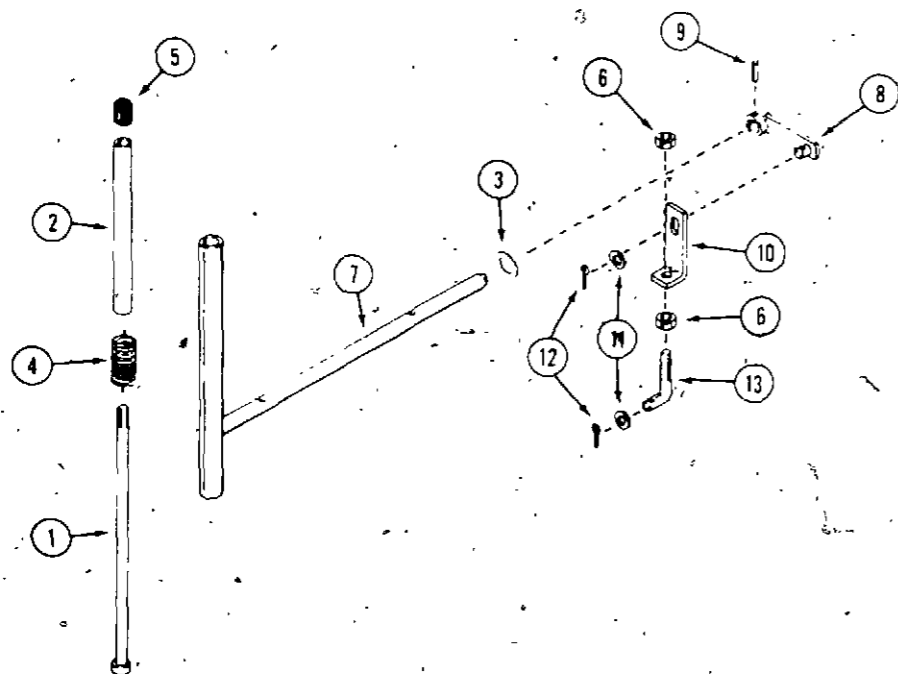

MOWER DECK

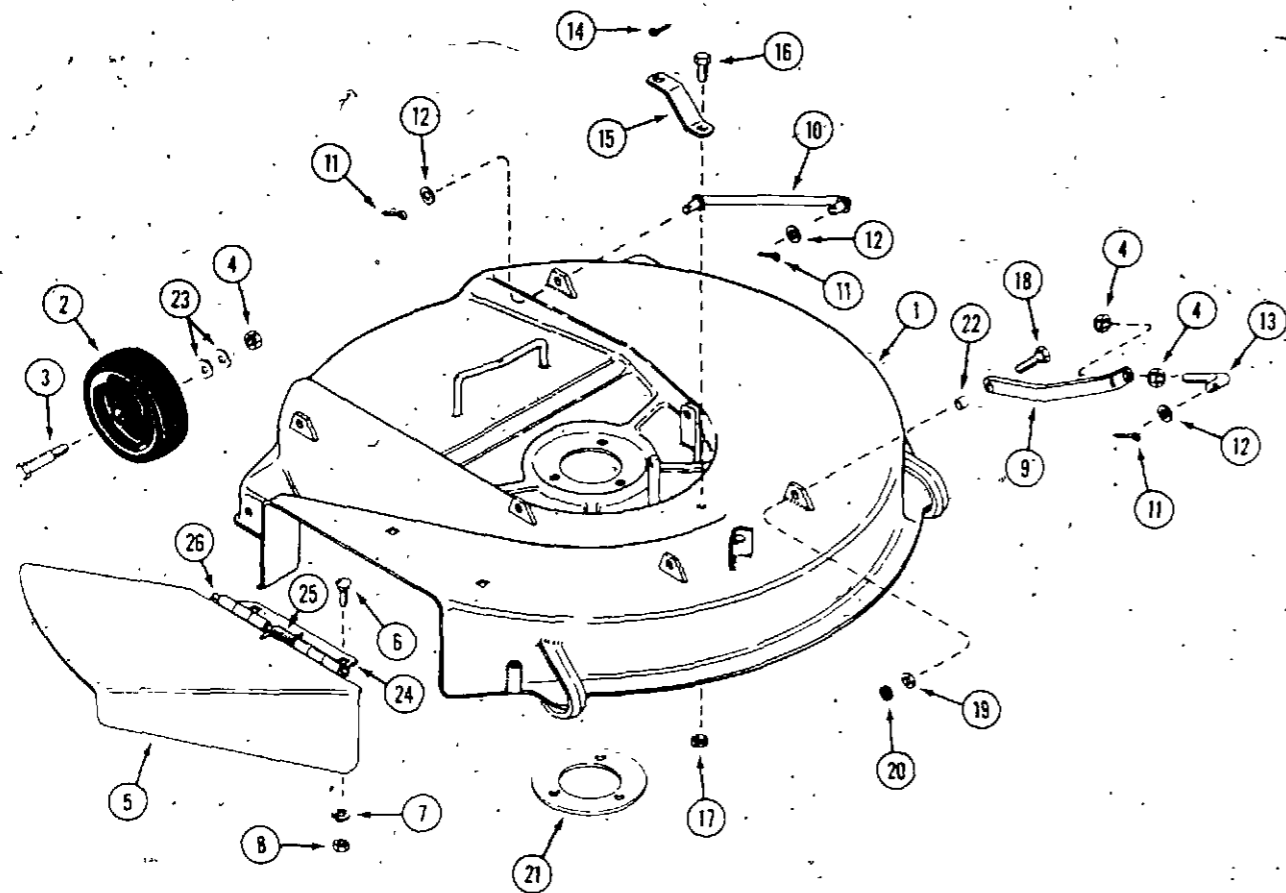

REF.	PART NO.	DESCRIPTION	REQ'D
1	C 25596	DECK - mower 30"	1
2	C 24455	WHEEL - anti-scalp	2
3	C 16745	BOLT - shoulder	2
4	131- 1181	NUT - lock 3/8" hex	6
5	C 25575	CHUTE	1
6	111- 132	BOLT - carriage 5/16" - 18 x 3/4"	2
7	192- 20	LOCKWASHER - 5/16"	2
8	129- 102	NUT - 5/16" - 18 hex	2
9	C 25551	LINK - connecting, L.H., front (shown)	1
9	C 25552	LINK - connecting, R.H., front	1
10	C 25554	LINK - connecting, rear (80XC) shown	2
10	C 29094	LINK - rear (80XE, 80XM)	2
11	132- 320	PIN - cotter, 3/32" x 3/4"	6
12	195- 525	WASHER - 3/8"	6
13	C 24314	BOLT - "J" level adjust	2
14	132- 310	PIN - cotter 1/8" x 1"	1
15	C 24268	BRACKET - pivot	1
16	113- 118	BOLT - 5/16" - 18 x 5/8"	1
17	131- 176	NUT - 5/16" - 18 lock	1
18	113- 4	BOLT - 1/4" - 20 x 1"	2
19	195- 518	WASHER - 1/4"	2
20	131- 1180	NUT - lock, 1/4" - 20	2
21	C 26442	PLATE - stiffener	1
22	C 25553	SPACER	2
23	195- 103	Washer	2
24	C 25578	BRACKET - hinge	1
25	C 25579	SPRING - hinge	1
26	C 25535	PIN - hinge	1

UAB

MOWER DRIVE ASSEMBLY

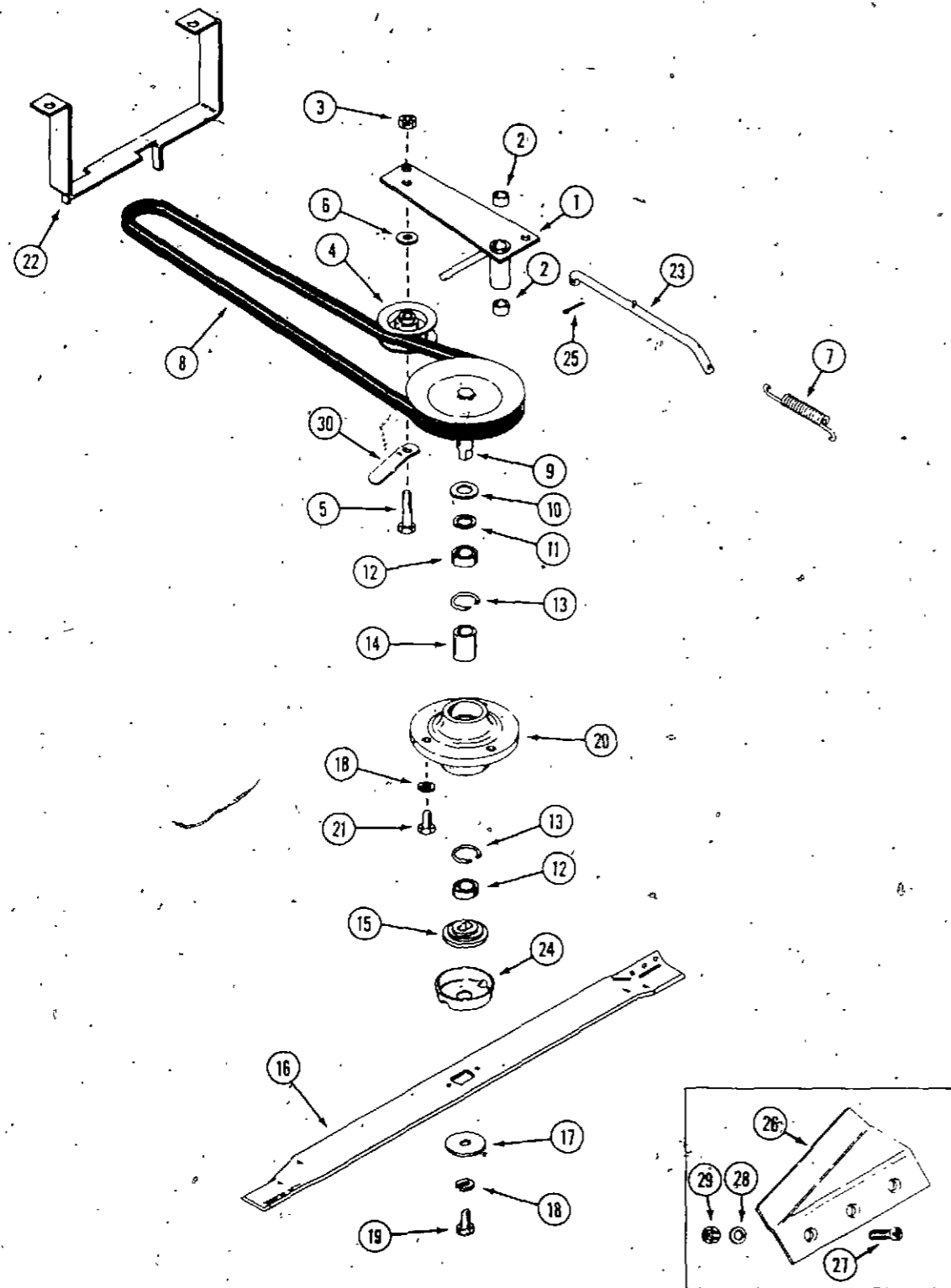

REF.	PART NO.	DESCRIPTION	REQ'D
1	C 29156	ARM - clutching (includes bushing)	1
2	C 17597	BUSHING - bearing	2
3	131- 1181	NUT - lock 3/8" - 16 hex	1
4	C 23542	PULLEY - "backside" idler	1
5	113- 233	BOLT - 3/8" - 16 x 1-3/4" hex	1
6	195- 136	WASHER - 3/8"	1
7	C 29103	SPRING - tension	1
8	C 24349	BELT - mower drive	1
9	C 24737	PULLEY AND SPINDLE ASSEMBLY - mower drive	1
10	C 10942	WASHER - spacer	1
11	C 28972	WASHER - spindle	1
12	C 28971	BEARING	2
13	C 16516	RING - retaining	2
14	C 24916	SPACER - bearing	1
15	C 25542	ADAPTOR - blade	1
16	C 23408	BLADE - mower (use in Europe)	1
16	C 30061	BLADE - mower, high lift (use in U.S.A.)	1
17	195- 2037	WASHER - 7/16" x 2"	1
18	192- 21	LOCKWASHER - 3/8"	4
19	113- 268	BOLT - 3/8" - 16 x 1" hex (torque 40 to 43 lb. ft. - 54 to 58 Nm)	1
20	C 24740	HOUSING - spindle	1
21	113- 206	BOLT - 3/8" - 16 x 3/4" hex	3
22	C 24850	GUIDE - belt	1
23	C 29165	LINK - clutch spring	1
24	C 25544	SHIELD - bearing	1
25	132- 320	PIN - cotter 3/32" x 3/4"	1
26	C 30069	WING - high lift (for use when bagging) optional	1
27	C 30072	SCREW - 5/16" - 18 x 3/4"	6
28	192- 20	LOCKWASHER - 5/16"	6
29	131- 176	NUT - 5/16" - 18 lock	6
30	C 25122	GUIDE - belt	1

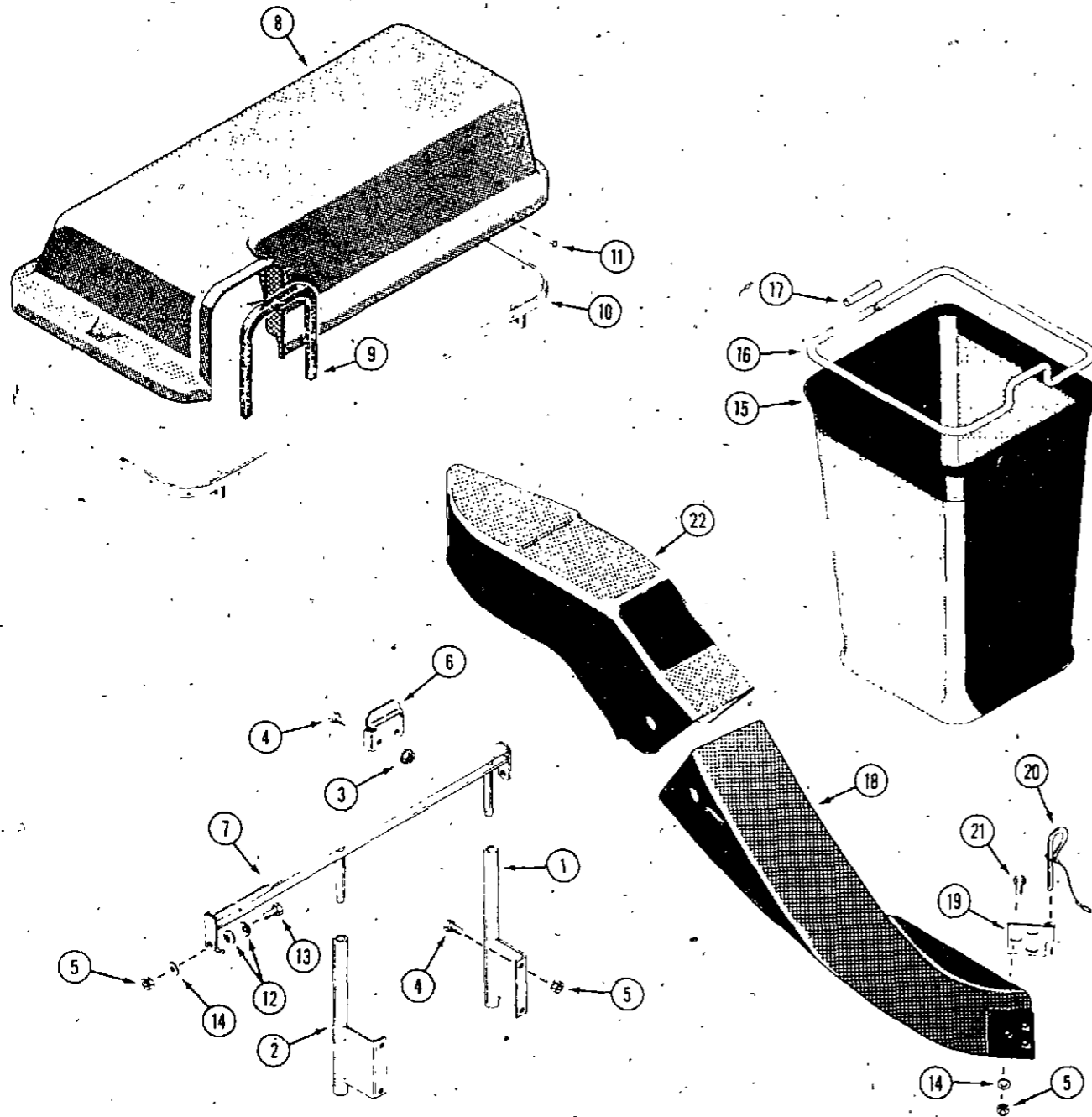

MODEL B95 BAGGER AND B93 REAR STAND KIT

B95 BAGGER

REF.	PART NO.	DESCRIPTION	REQ'D
1	C 29061*	BRACKET - mounting L.H.	1
2	C 29059*	BRACKET - mounting R.H.	1
3	131- 911	NUT - flange 5/16"	4
4	113- 102	BOLT - 5/16" - 18 x 3/4"	8
5	131- 176	NUT - 5/16" - 18	9
6	C 28436	BRACKET - retaining	2
7	C 28434	FRAME - support	1
8	C 29870	COVER - bagger	1
9	C 24610	SEAL - chute	1
10	C 29871	HINGE - cover	1
11	151- 88	RIVET - 3/16" x 5/16"	17
12	C 25114	SPRING WASHER - Belleville	4
13	113- 103	BOLT - 5/16" - 18 x 1"	2
14	195- 521	WASHER - 5/16"	5
15	C 28438	BAG	2
16	C 28439	REINFORCEMENT - bag	2
17	C 28440	TUBE - connector	2
18	C 28492	CHUTE - extension, lower	1
19	C 24514	PLATE - chute mounting	1
20	C 24492	PIN ASSEMBLY - mounting	1
21	111- 202	BOLT - 5/16" - 18 x 3/4" carriage	3
22	C 28448	CHUTE - extension, upper	1
23	321- 4447	DECAL - "Spinning Blade"	1
23	321- 4750	DECAL - "Spinning Blade" (French)	1
24	C 31086	DECAL - "Flying Debris"	1
25	321- 4446	DECAL - "Flying Debris" (French)	1
25	321- 4761	DECAL - "Flying Debris" (French)	1
	C 30985	DECAL - "INGERSOLL"	1

B93 REAR STAND KIT

1	C 29061*	BRACKET - mounting L.H.	1
2	C 29059*	BRACKET - mounting R.H.	1
4	113- 102	BOLT - 5/16" - 18 x 3/4"	4
5	131- 176	NUT - 5/16" - 18	4

WARNING
SPINNING BLADE
 SEE OPERATOR'S MANUAL BEFORE ATTEMPTING TO CLEAR PLUGGED DISCHARGE CHUTE. CONTACT WITH BLADE CAN RESULT IN SERIOUS INJURY.

23

WARNING
FLYING DEBRIS
 OPERATE MOWER ONLY WITH DISCHARGE CHUTE GUARD/COVER OR COMPLETE GRASS CATCHER IN PLACE. DEBRIS MAY CAUSE INJURY.

24

CAUTION
FLYING DEBRIS
 1. DO NOT RAISE COVER WHILE OPERATING.
 2. PROPERLY INSTALL BAGGER AND CHUTE BEFORE STARTING MOWER. SEE OPERATOR'S MANUAL FOR FURTHER INSTRUCTIONS.

25

*You must order both of these brackets if your original bracket is perpendicular to the rear of the tractor. The new bracket is designed to angle forward.

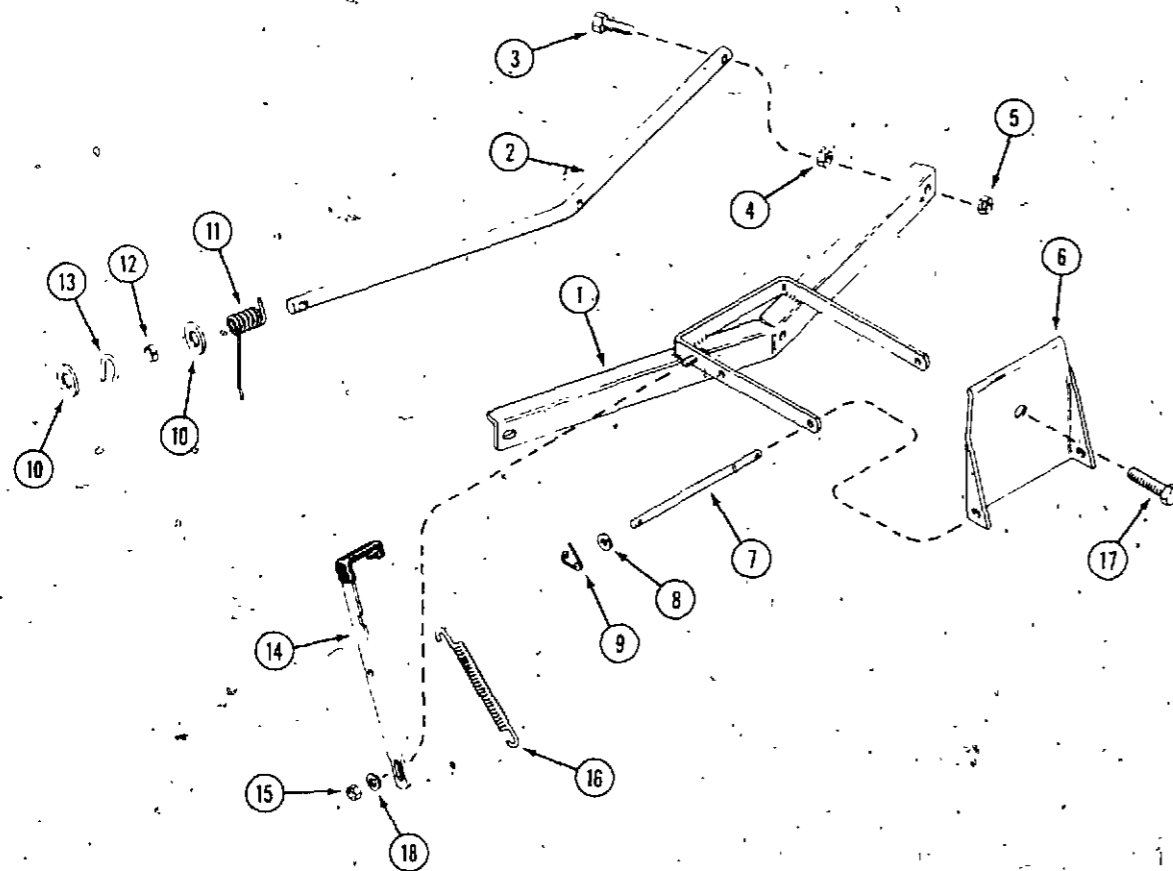

MODEL M92 THATCHER

THATCHER ATTACHMENT

REF.	PART NO.	DESCRIPTION	REQ'D
1	C 24917	FRAME - thatcher	1
2	C 24921	ROD - mounting, springs and pawls	1
3	113- 122	BOLT - 5/16" - 18 x 1-1/2" hex	3
4	129- 102	NUT - 5/16" - 18 hex	3
5	131- 176	NUT - lock, 5/16" - 18	3
6	C 24924	BRACKET - mounting	1
7	C 24919	ROD - pivot, front	1
8	195- 104	WASHER - 3/8"	2
9	C 10883	PIN - safety	2
10	C 25263	WASHER - (4 on early production)	2
11	C 26109	TINE - spring	25
12	C 24960	CLIP - pawl spacer (early production)	2
13	C 24923	PAWL - lift (early production)	2
14	C 29644	HANDLE - lift	1
15	131- 1180	NUT - lock, 1/4" - 20	1
16	C 19553	SPRING	1
17	113- 421	BOLT - 1/2" - 13 x 2" hex	1
18	195- 518	WASHER - 9/32" x 5/8"	1

